

Home
50 metre FDHF Hybrid



*At Heesen we don't
just build yachts.
We turn dreams
into reality.*



Heesen
1978

From day one, Heesen has pursued a consistent mission: to create yachts with exceptional standards of engineering and meticulous attention to detail.

To achieve this, skilled hands, driven by a passion for perfection, make all the difference. They are able to fulfil every customer's dream. Each yacht is built entirely in-house, using the strongest aluminium and the toughest steel. This craftsmanship is matched by an unparalleled hunger for innovation and

challenge. The result: designs that continue to push the limit and set the industry's benchmark. But the Heesen experience goes beyond building a perfect yacht. It's all about exceeding the client's expectations with first-class service at all times, throughout the customer journey.

A yacht is a beautiful way to travel the world in luxury and expand your horizons. At Heesen, we create yachts on which the journey is as enjoyable as the destination.

Exterior Design

The exterior of Home is designed by Omega Architects and it's our first yacht with hybrid propulsion. In this case 'Hybrid' means that the yacht can draw on two sources of power for propulsion: diesel mechanical and diesel electrical. Either or both sources can be used at the same time. This provides less noise and vibration, a more flexible power management which means better efficiency.





home

F 500000000





Silence & comfort

Home is all about fuel efficiency and comfort. Her lightweight aluminium hull form offers superlative performance and efficiency in a luxurious design package of under 500GT. Add a striking superstructure, vertical bow and spacious aft platform with a wide staircase leading to the main deck and we believe this yacht is a cut above others in her class.



16.3 knots long range

Home has a transatlantic range of 3,750 nautical miles at a cruising speed of 12 knots. Her top speed of 16.3 knots is remarkable for a displacement yacht of her size. The hybrid propulsion operates near-silent in electric mode. Moreover, Home achieves lower fuel consumption and a higher top speed when the diesel engines and electric motors are combined.



High performance

The efficient hull form allowed our engineers to install smaller engines that use less space. This means lower fuel consumption without compromising performance and leaves more room to enjoy the yacht to her fullest. Home is a high-performance, supremely comfortable fast displacement yacht with reduced environmental impact. The best of both worlds.

Hybrid Solution

With our ever-increasing desire to minimise environmental impact, coupled with the enormous improvement in alternative power systems, Home's hybrid engine system embraces the very best of 21st century technology. The hybrid system offers irresistible advantages over a conventional diesel-powered system: it's cleaner, quieter and more fuel efficient.

The engine can be operated in four different cruising modes depending on your priorities.

Hybrid mode

So you want to go places, but you're not in too much of a hurry. Hybrid mode will drive the yacht at speeds up to 9 knots, when the power is derived purely from Home's e-motors and generators. With just a maximum of 46 dB(A) – the sound of softly falling rain - in the owner's stateroom, hybrid mode is beautifully silent and engine vibration is imperceptible because the generators are insulated and boxed. What's more, fuel consumption is extremely low, running at no more than 70 litres per hour.

Economic mode

Between 12 and 15 knots, you have the option to switch off the generators and run off the main engines alone with the e-motors supplying the hotel load.

Cruising mode

This is what you'd describe as the most conventional mode, when the main engines are driving the yacht's propellers along with the generators providing power to the hotel load, and the e-motor is switched off. In cruising mode, this yacht is capable of speeds up to 16.3 knots.

Boost mode

If you're really in a hurry and want to hit the yacht's top speed of 16.8 knots, boost mode will get you there. This is when you're running on your main engines, the generators, and you're feeding the e-motor on the gear box.

Sounds complicated? Well, the technology is complex, yes. But operation is simplicity itself. And the benefits - particularly when you've experienced the smooth and silent operation at lower speeds - are fantastic for you and the environment.

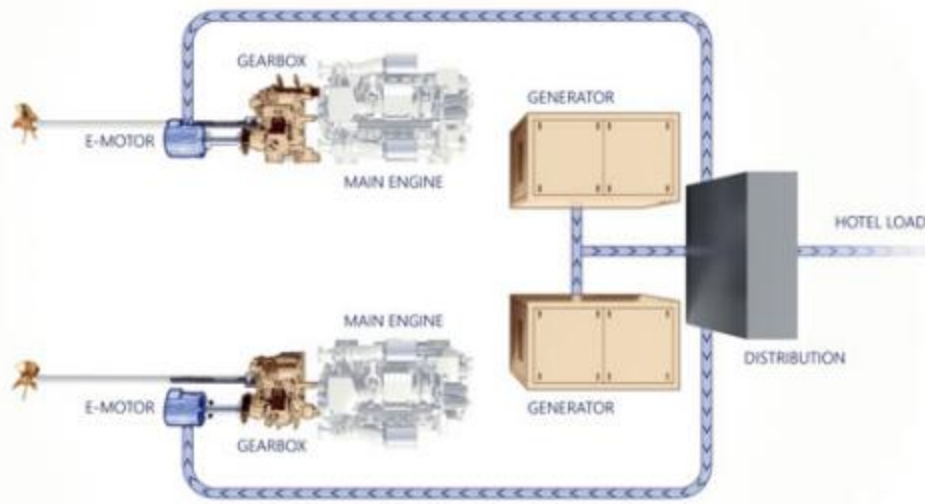

Hybrid mode

Electric propulsion
 Main generators on / main engines off
 E-motors providing mechanical power (propulsion)
 Speed up to 9 knots

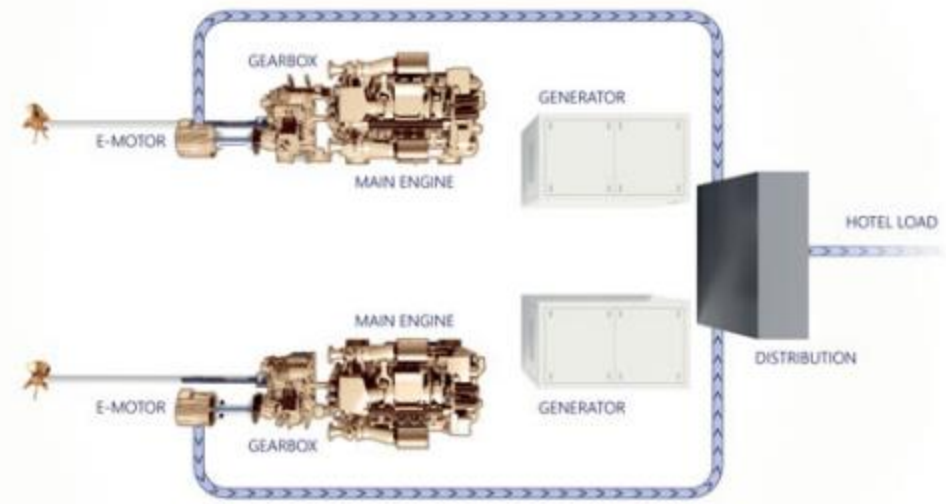

Economic mode

Diesel propulsion
 Main generators off / main engines on
 E-motors providing electric power (hotel load)
 Speed from 12 to 15 knots

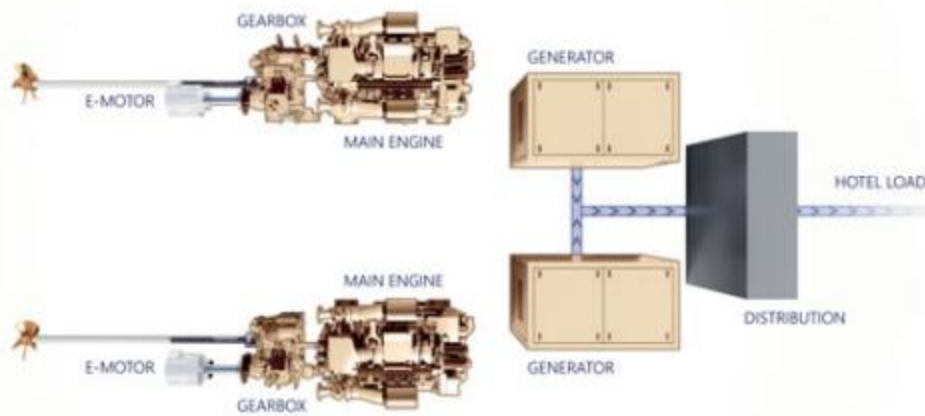

Cruising mode

Diesel propulsion
 Main generators on / main engines on
 E-motors off
 Speed up to 16.3 knots

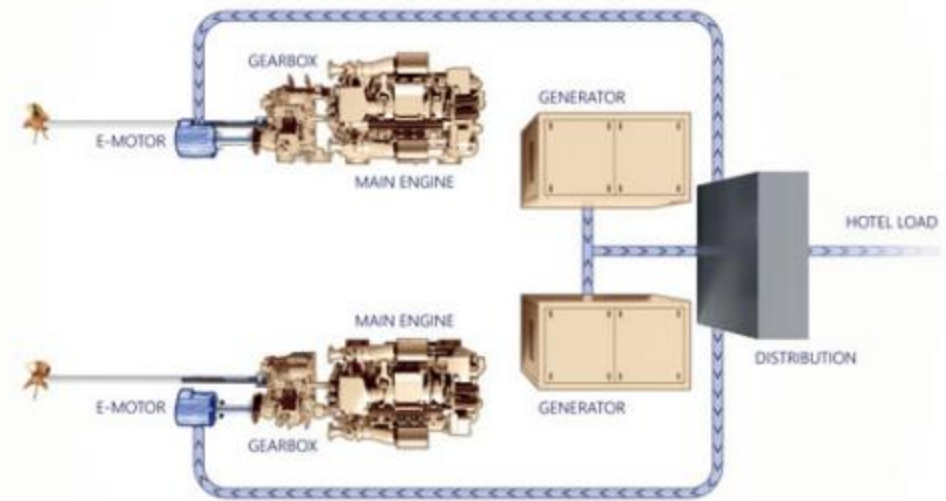

Boost mode

Diesel and electric propulsion
 Main generators on / main engines on
 E-motors providing mechanical power (propulsion)
 Speed up to 16.8 knots

Interior Design

The brief to Cristiano Gatto with regard to the interior styling was to provide a relaxed and welcoming beach club ambience with ample connection to the outside environment. To achieve this objective, Cristiano and his team have drawn on natural materials with minimal artificial treatments and taken full advantage of the full-height glass windows.

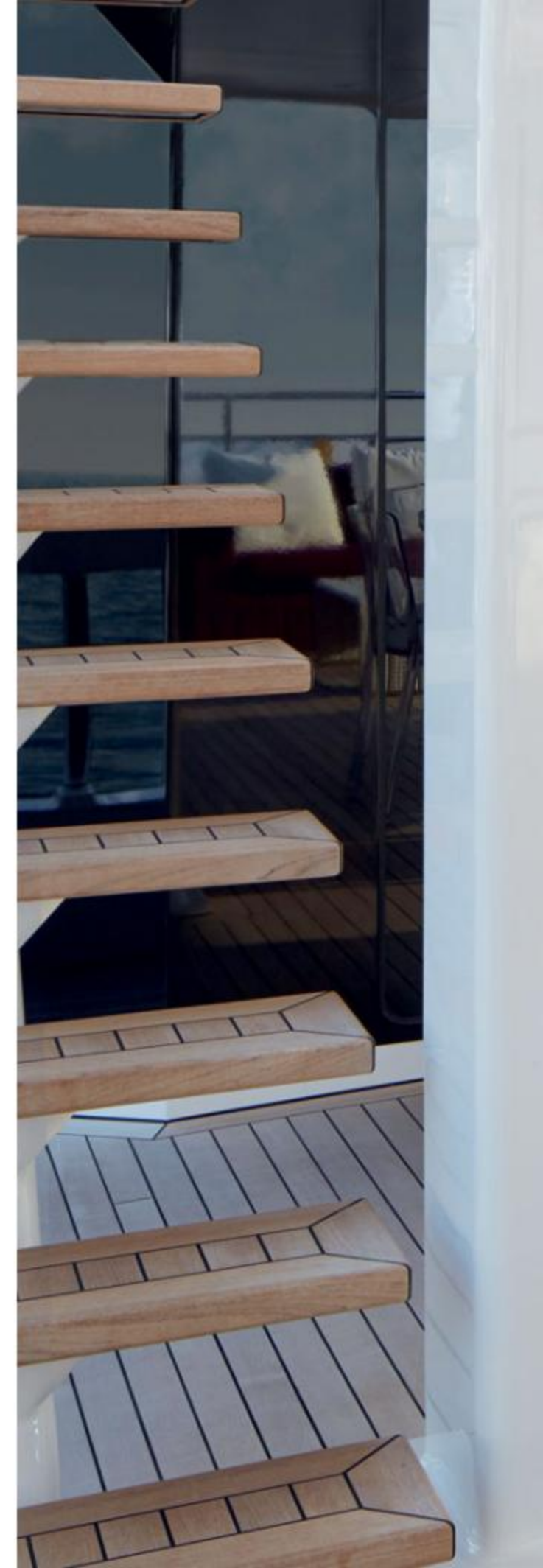







Light-filled & relaxing

Main saloon

The full-beam main saloon and full-height windows provide a light-filled relaxing ambience and extraordinary sea views. Furthermore, the glass sliding doors onto the open aft deck serve to diminish the barrier between interior and exterior.



Space to spare
Owner's stateroom

The full-beam owner's stateroom is positioned on the main deck forward with private study, spacious bathroom behind the suite and an enormous walk-in wardrobe. An optimal balance between privacy, space and luxury.







Smart layout
Guest suites

On the lower deck, Home has no less than five guest suites including a full-beam guest suite. Designed to impress using only the very best materials, a stay in one of Home's guest accommodations is one to remember. It goes without saying that the layout is designed so that all the guest areas can be discreetly serviced by the crew.

Swimming platform

Another innovation is the wide central staircase leading from the generous swim platform to the main deck aft that provides a grand entrance when arriving by tender. To maximise the size of the fixed swim platform, which is sheltered between the hull bulwarks for protection from the wind and to enhance privacy, the tender is stowed out of sight in a recessed bay on the foredeck.





Home

50 metre FDHF Hybrid



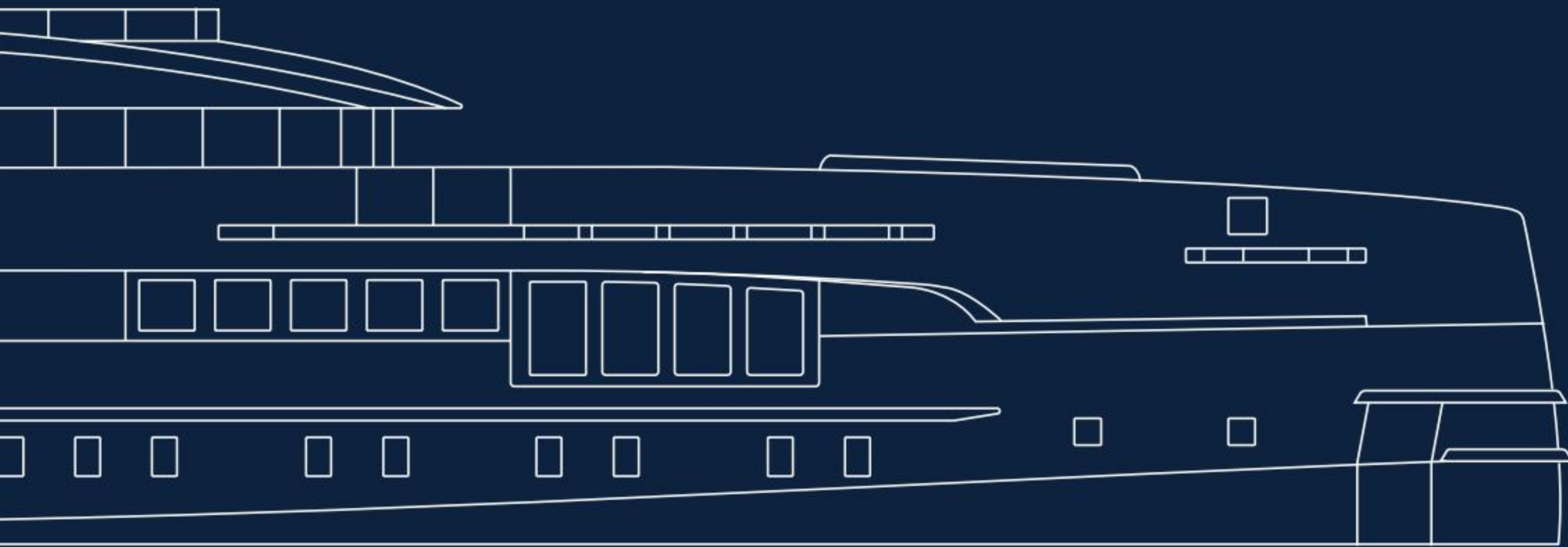

Technical drawings

Home
50 metre FDHF Hybrid

Sun deck

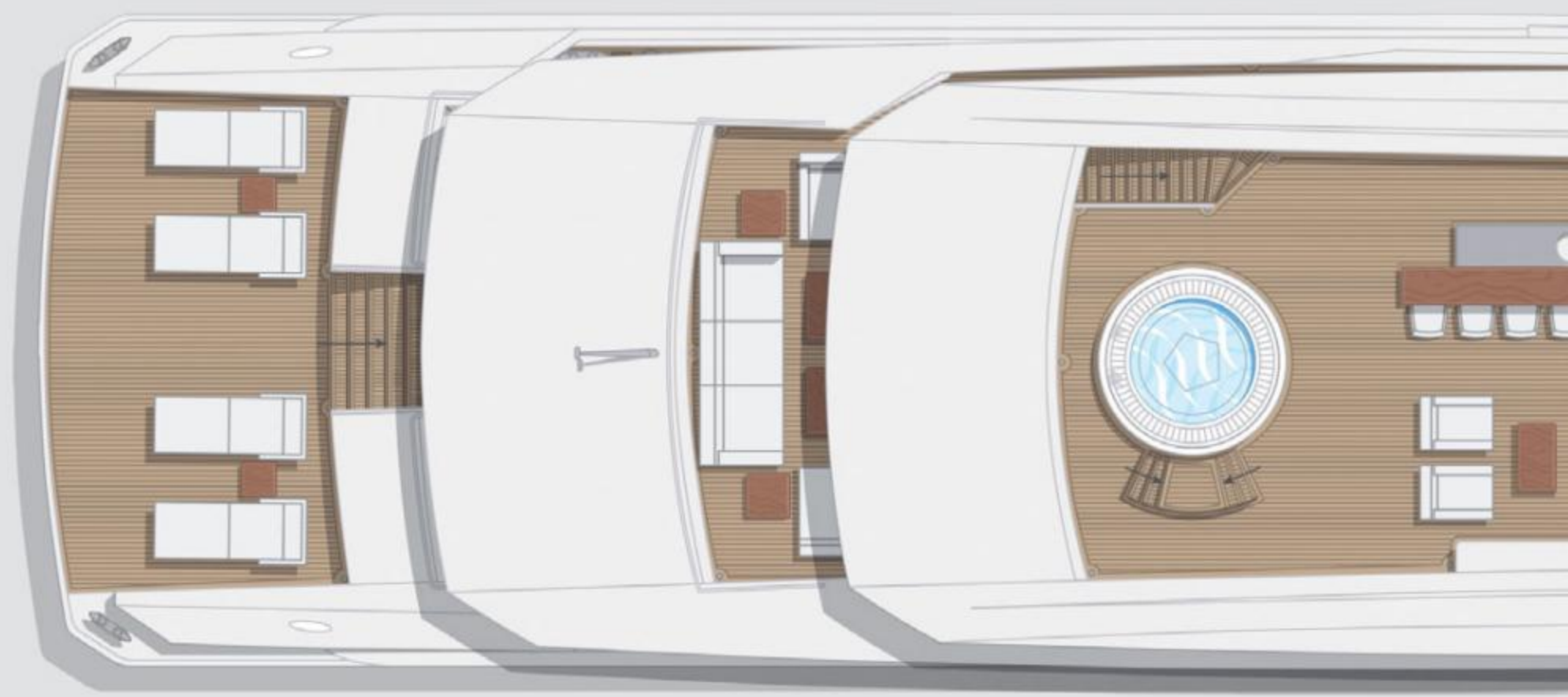

Upper deck



Home



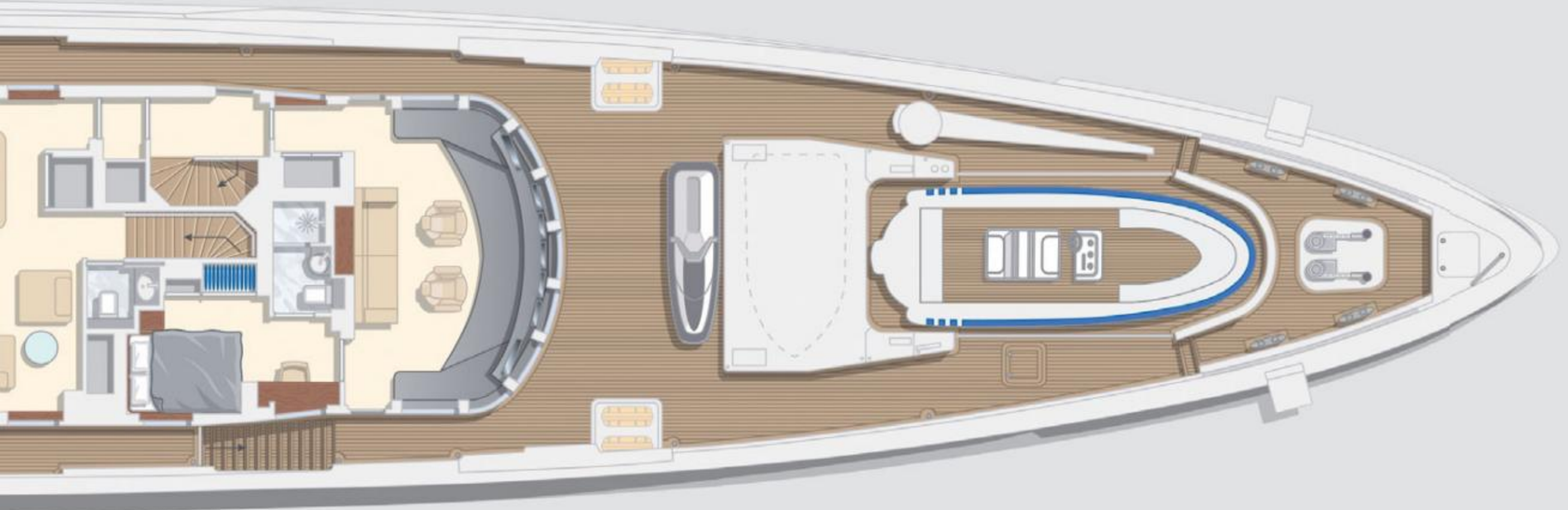
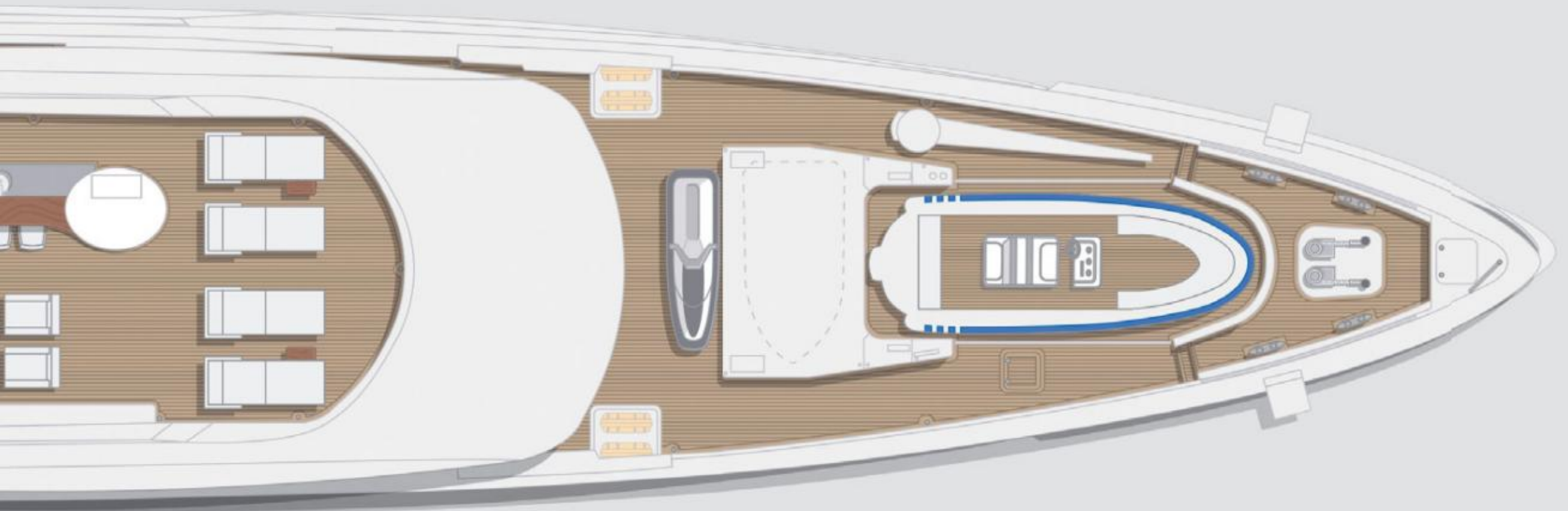

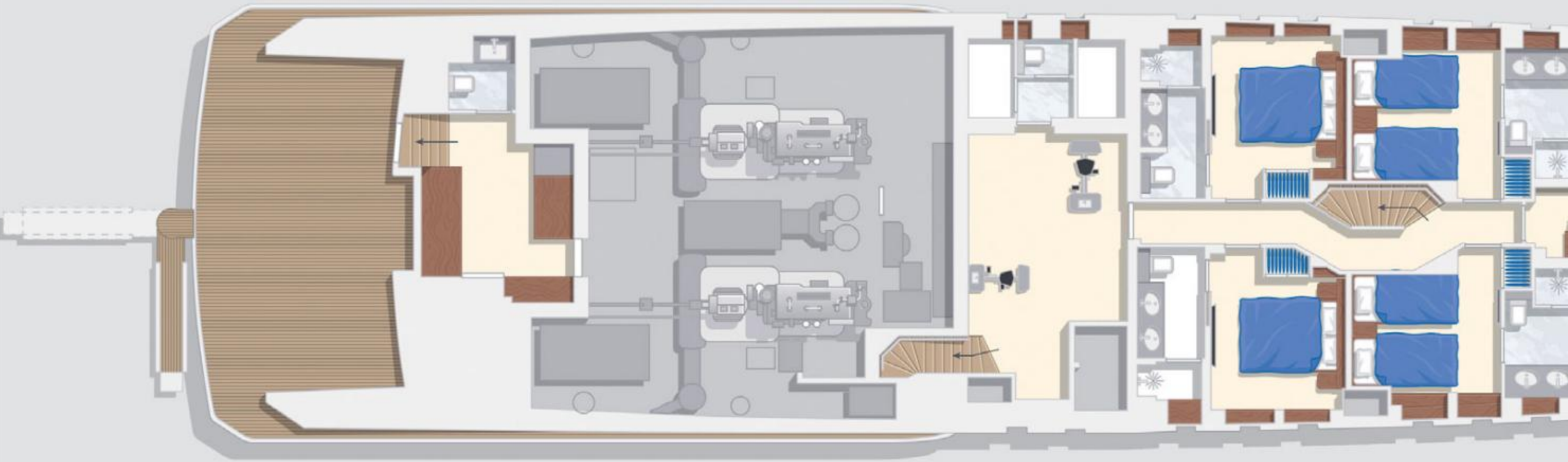

0

10

20

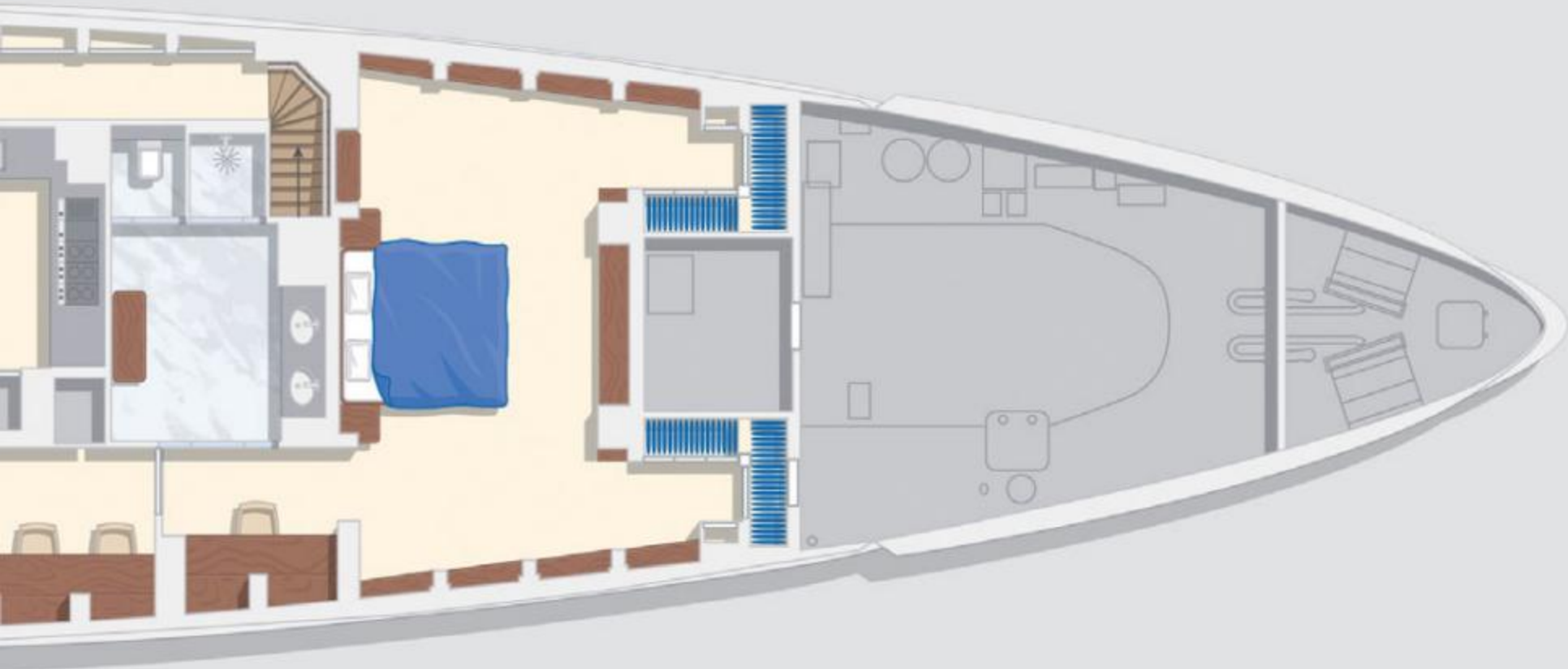

Main deck

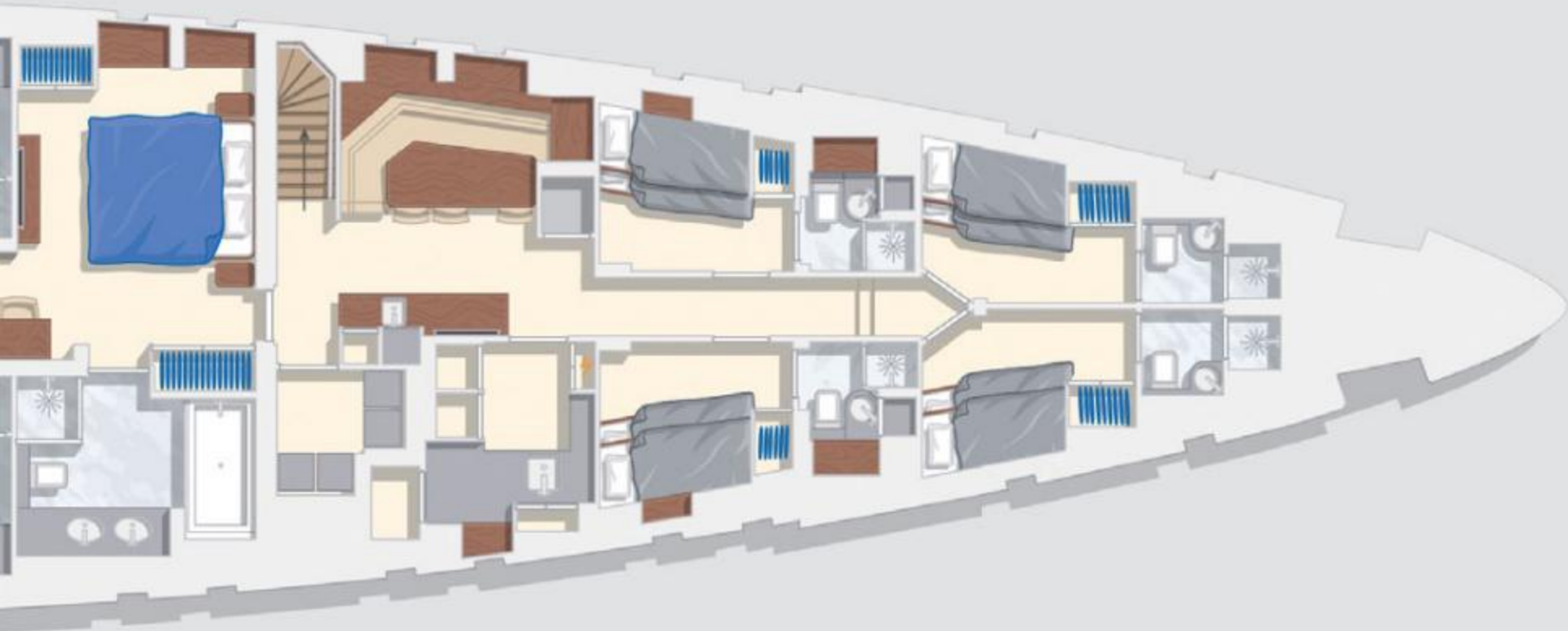

Lower deck

Specifications

50 metre FDHF Hybrid



General

Hull type:	Twin propeller, FDHF
Naval architect:	Van Oossanen / Heesen Yachts
Exterior design:	Omega Architects
Interior design:	Cristiano Gatto Design
Classification:	ABS ✱ A1 Commercial Yachting Service [✱] AMS Large Commercial Yacht Code LY3
Hull:	Aluminium
Superstructure:	Aluminium

Dimensions

Length over all:	49.80 metres / 163 feet 4 inches
Beam over all:	9.10 metres / 29 feet 10 inches
Draft:	2.15 metres / 7 feet 1 inch
Displacement (half load):	Approx. 315 tons
Tonnage:	Approx. 499GT

Accommodations

Crew:	9
Guests:	12
Cabins:	Full-beam owner's stateroom, one full-beam VIP cabin, two double guest cabins and two twin guest cabins

Technical Details

Maximum speed (half load):	16.3 knots (diesel direct) 9 knots (diesel electric)
Range at 12 knots:	3,750Nm
Fuel capacity:	45,000 litres / 11,900 US gallons
Fresh water:	16,000 litres / 4,200 US gallons

Propulsion Details

Main engines:	2 x MTU 12V 2000 M61
Maximum power:	2 x 600kW
Gearbox:	2 x ZF 3310
Engine control:	MTU Blue Vision
Propellers:	2 x Five blade fixed pitch
Main generators:	2 x Zenoro dual speed 184 ekW @ 1,800 rpm 159 ekW @ 1,500 rpm
Bowthruster:	ZF-Marine 90kW, electrically driven
Stabilisers:	Naiad Dynamics, 2 fins, type 720, zero speed

