

XVENTURE



WINCH DESIGN





**“Twenty years from now you will be more
disappointed by the things that you didn’t do
than by the ones you did do. So throw off the bowlines.
Sail away from the safe harbor.
Catch the trade winds in your sails.
Explore. Dream. Discover.”**

Mark Twain

ADVENTURE KNOWS NO
LIMITS, AND XVENTURE
IS THE YACHT ON WHICH
TO REALISE THAT VISION







MARK CAVENDISH

MARKETING AND SALES DIRECTOR AT HEESSEN YACHTS

THE DAWN OF DISCOVERY

ADVENTURE KNOWS NO LIMITS, AND XVENTURE IS THE YACHT ON WHICH TO REALISE THAT VISION. ESSENTIALLY, XVENTURE WILL TAKE YOU OFF-ROAD, BUT IN HEESSEN COMFORT AND STYLE. BUILT UPON A FOUNDATION OF SOLID DUTCH CONSTRUCTION, IT'S THE ULTIMATE YACHT FOR SAFE EXPLORATION AT SEA.

XVenture is the first of her kind. Possessing Heesen's renowned DNA and proven engineering, she answers a new calling within yachting – that of vastly remote cruising. Offering long range, a robust build, helicopter capability, and vast storage space she is tough, independent, exhilarating and daring. A true Heesen explorer yacht, XVenture is the dawn of a new breed.

Experiential luxury travel has rapidly gained momentum, thanks in no small part to a younger generation of yacht owners and their zest for adventure. For Heesen, XVenture answers this calling.

"We believe the recent rise in popularity of explorer yachts stems from humanity's universal and enduring interest in discovery and adventure," says Mark Cavendish, Marketing and Sales Director at Heesen. "Humans are driven to explore the unknown. The hunger to discover new worlds runs deep in our DNA, as does the desire to push the boundaries of our scientific and technical limits."

The thrill of owning a yacht is about the freedom to, not freedom from, he adds: "Yacht owners are free to do, free to go wherever they choose. In support of this, we have witnessed an increasing number of our owners taking their Heesen yachts to venture off the beaten track. Far flung destinations, which previously remained out of bounds for most, are now a reality for yacht owners."

'Far flung destinations, which previously remained out of bounds for most, are now a reality for yacht owners'

"Central to the unique experience of cruising on board a superyacht are the strong and lasting bonds that are forged between family and friends. Add to that mix the thrill of sharing adventures in remote corners of the world, and it's easy to understand the current appetite for explorer yachts. As much at home in the wilds of Alaska as sitting pretty in the glamorous port of Monaco, our Winch-designed XVenture is conceived to cross the world's oceans."

Exploration is all about growth, discovery and learning. It is what makes us tick. True to form, XVenture is a highly versatile yacht. Conceived to light a fire in the imagination of young, intrepid explorers, versatility is at the core of her design. She carries the option of hybrid propulsion, longer range cruising and a fifth guest cabin. Free to be styled around an owner's requirements and lifestyle, even the expansive toy chest can be customised to suit specific needs.

Notable standout features on board XVenture include a stunning three-deck crystal elevator, a swimming pool with Jacuzzi, a winter garden below the helideck and convertible cabins for maximum accommodation. Ice Class is also an option. But for most owners, the ability to create life-affirming adventures with friends and family is the key to the experience. Whether traversing Arctic glaciers, heli-fishing in Japan or heading up the Amazon, XVenture makes even the most remote family holiday a reality.

"Perfectly at home in the wilderness while offering five-star amenities one can only experience aboard a superyacht, it provides owners with the luxury of carrying a wide range of tenders and toys to explore both sea and land," says Cavendish. "Essentially, XVenture will take you off-road, but in Heesen comfort and style."

'Perfectly at home in the wilderness while offering five-star amenities one can only experience aboard a superyacht'



AS FAR AS YOUR IMAGINATION WILL TAKE YOU

From close encounters with whales in Alaska to heli-skiing in Chili. And from exploring the wild Down Under to venturing into the deep blue waters of Tahiti. With the right yacht and the right toys there's so much to enjoy in this world. World-renowned photographer, filmmaker and adventurer Morgan Maassen shares his hidden gems with us.



MORGAN MAASSEN
PHOTOGRAPHER

Morgan Maassen is a 28-year-old photographer and film-maker from Santa Barbara, California. Having been at one with the sea from the moment he can remember, his work transcends borders and unlocks the beauty of a land less ventured.

BEHIND THE LENS

WHEN DID YOU FIRST PICK UP A VIDEO CAMERA?

"I began shooting video when I was 13-years-old with the family Camcorder, after a surfing accident took me out of the water for a month. From there, I saved up money through a plethora of odd-jobs to invest myself more into making films about surfing, travelling, art, my friends and our adventures growing up."

'From the moment I was born, I was both encouraged to engage with the sea, and drawn to it through the hobbies and passions I developed as a child'

HOW DID A PASSION FOR FILM TURN INTO PHOTOGRAPHY?

"At the age of 18, I decided to try shooting stills to accompany my videos, and I fell in love immediately. I began shooting anything and everything I could amongst my schedule of school and work. After taking some time to travel, I started receiving job offers via my website and blog, and made the switch to being a full-time photographer. Now, I am fortunate enough to spend my time equally between filmmaking and photography, working with brands such as Apple, Mercedes-Benz, Corona, National Geographic, and the New York Times. I spend as much time as possible on the road, both for work and pleasure, as I'm always trying to shoot something across the spectrum of mediums. When I am home, all my free time is dedicated to surfing, hiking, tennis, art, and my dog, Moose."

WHERE DOES YOUR PASSION FOR THE SEA AND ADVENTURE COME FROM?

‘From the moment I was born, I was both encouraged to engage with the sea, and drawn to it through the hobbies and passions I developed as a child’. My father was a fisherman, and my mother worked in environmental non-profits centred around helping the ocean. So combined with their backgrounds, and my absolute love for the beach, I flourished and formed an almost immediate and passionate natural connection to water. I fell into sailing, diving, surfing, fishing, photographing, filmmaking, and ultimately travelling around the sea.”

WHERE ARE THE MOST MEMORABLE PLACES THAT THIS PASSION FOR ADVENTURE HAS LED YOU?

“By channelling my creativity and excitement into capturing the sea, I have been fortunate enough to take on opportunities to travel the world and visit all of the oceans and as many seas as possible. Tahiti truly wins for its pristine natural beauty; the way the mountains so magnificently meet the sea, where the water is crystalline and filled with whales and sharks – it keeps me awake at night, and when the world-famous wave Teahupo’o starts breaking, you’re hard-pressed to find me anywhere else. I also love the Basque Country of France, and the way the Atlantic Ocean sends the storms rolling down its coast in winter. And Iceland and Greenland for their theatrical landscapes and frigid water, which has pushed me to my limits.”

WHAT HAVE BEEN THE MOST REWARDING OUTCOMES FROM YOUR TRAVELS?

“Being able to travel the world exploring the oceans has allowed me to connect with so many like-minded people. ‘Common themes that run through my work are adventure, sustainability, and a passion for wildlife’ It’s been an honour to collaborate with so many brilliant people across a multitude of cultures, but most importantly to be able to experience new lands, see wildlife, and marvel at the beauty of the Earth.”

‘Common themes that run through my work are adventure, sustainability, and a passion for wildlife’



ALASKA

64.2008° N 149.4937° W

READY FOR XVENTURE: ALASKA

WHERE:

Glacier Bay, Alaska and the surrounding islands.

WHEN:

"The best time of year to visit would be September to October when there are beautiful sunsets and the chance to see the Northern Lights, as well as a changing of the seasons which makes for more dramatic scenery and visuals."

UNIQUE:

"The glaciers of Glacier Bay are second to none. Being able to sail through the ice fields and see the glaciers calve is the experience of a lifetime, set against a backdrop of breaching whales and bears roaming the shoreline hunting for salmon."

WHAT TO BRING:

"While the end of summer can herald California-like weather, proximity to the icefield brings about cold wind, freezing air, and when the sun dips, nights are often frigid. Xventure's Pascoe DT Beachlander is ideal for navigating the ice and being able to get to shore."

SPECIAL ENCOUNTERS:

"To see the humpback and grey whales dance among the ice is truly magical, while otters and eagles pepper the landscape. Make sure to have a good pair of binoculars."

CONSERVATION:

"Alaska is incredibly well managed as a series of national parks, reserves, and preserves. I find it immensely uplifting to be able to visit a place, especially by superyacht, where the government agencies work hard to limit your impact, yet still enjoy your visit to its full extent."

'HUMPBACK AND GREY WHALES DANCE AMONG THE ICE, WHILE OTTERS AND EAGLES PEPPER THE LANDSCAPE'

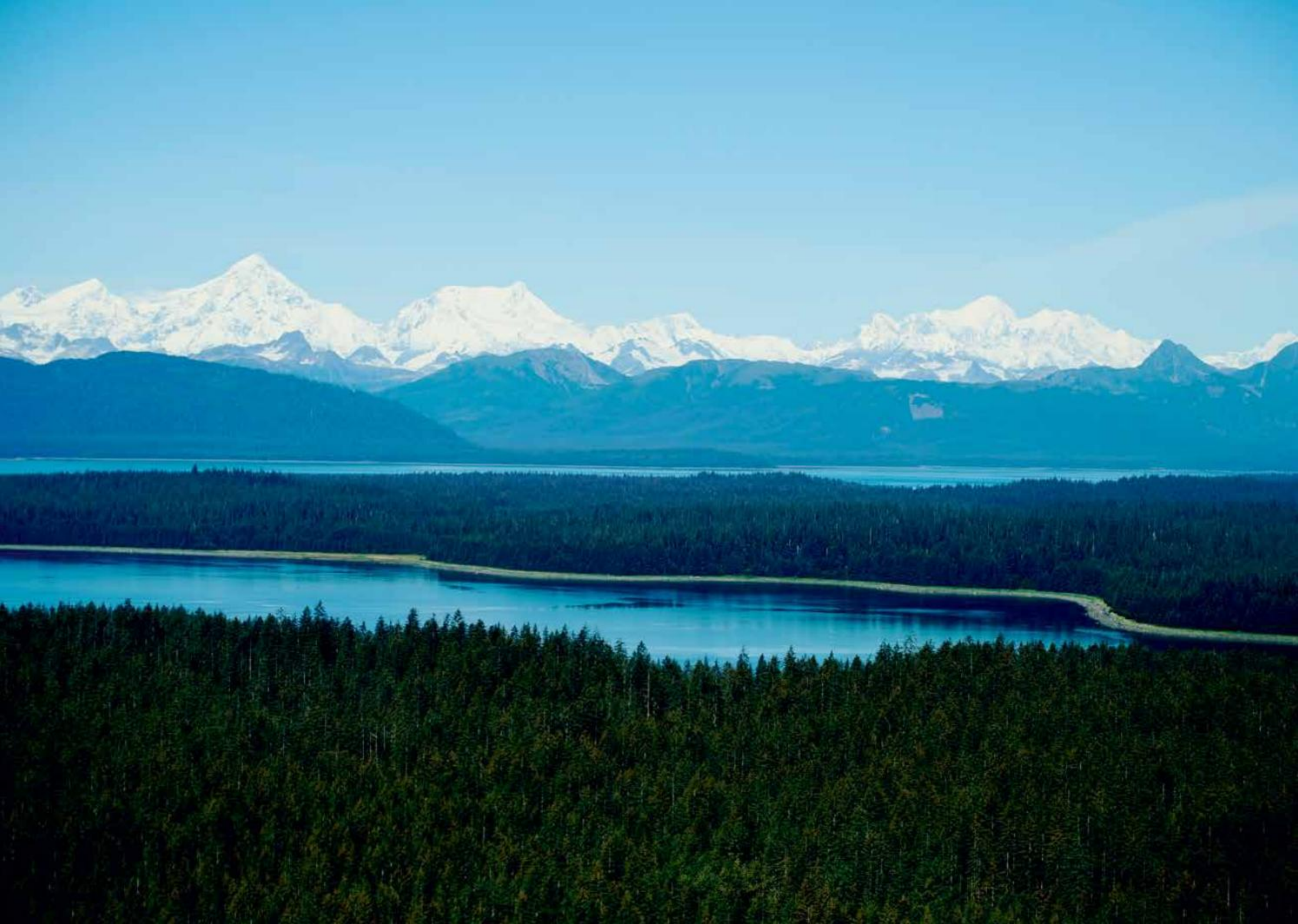





**'BEING ABLE TO SAIL
THROUGH THE ICE FIELDS
AND SEE THE GLACIERS
CALVE IS THE EXPERIENCE
OF A LIFETIME'**



CHILE

35.6751° S 71.5430° W

READY FOR XVENTURE: CHILE

WHERE:

"Sailing the coast of Chile is no easy feat; it is long, rugged, dramatic and prone to big swells. However, the coastline offers some of the most beautiful bays, breath-taking scenery and untouched land and beaches I've ever seen."

WHEN:

"November to January would bring the calmest, warmest weather, whereas June to August is winter and delivers incredible snow to the mountains."

UNIQUE:

"Heli-skiing amongst the volcanos of Chilan on board XVenture's Airbus H135 helicopter is a sight to behold, as magma spews from mountain tops and hot springs wait for you at the bottom of every run."

WHAT TO BRING:

"Snow equipment with comfy swimwear to fit underneath. Nothing compares to bombing down a mountain, taking off your clothes and jumping into a hot spring while the helicopter lands for your next run."

SPECIAL ENCOUNTERS:

The wine from central Chile is delicious, and watching giant condors fly overhead in the Andes will take your breath away. Wild horses roam everywhere, and if you are strong enough, take a dip in a glacial river."

SUSTAINABILITY:

"Chile is one of the most advanced countries and cultures of South America. When visiting places like the Andes, you are reminded everywhere that they are one of the most important and sacred ecological regions in the world. Along the coastline, you'll witness incredible local initiatives to curb pollution and restore habitats, working hard to protect the gorgeous country as Santiago continues to grow into one of the largest cities in the world."

**'YOU ARE REMINDED
EVERYWHERE THAT THEY
ARE ONE OF THE MOST
IMPORTANT AND SACRED
ECOLOGICAL REGIONS IN
THE WORLD'**





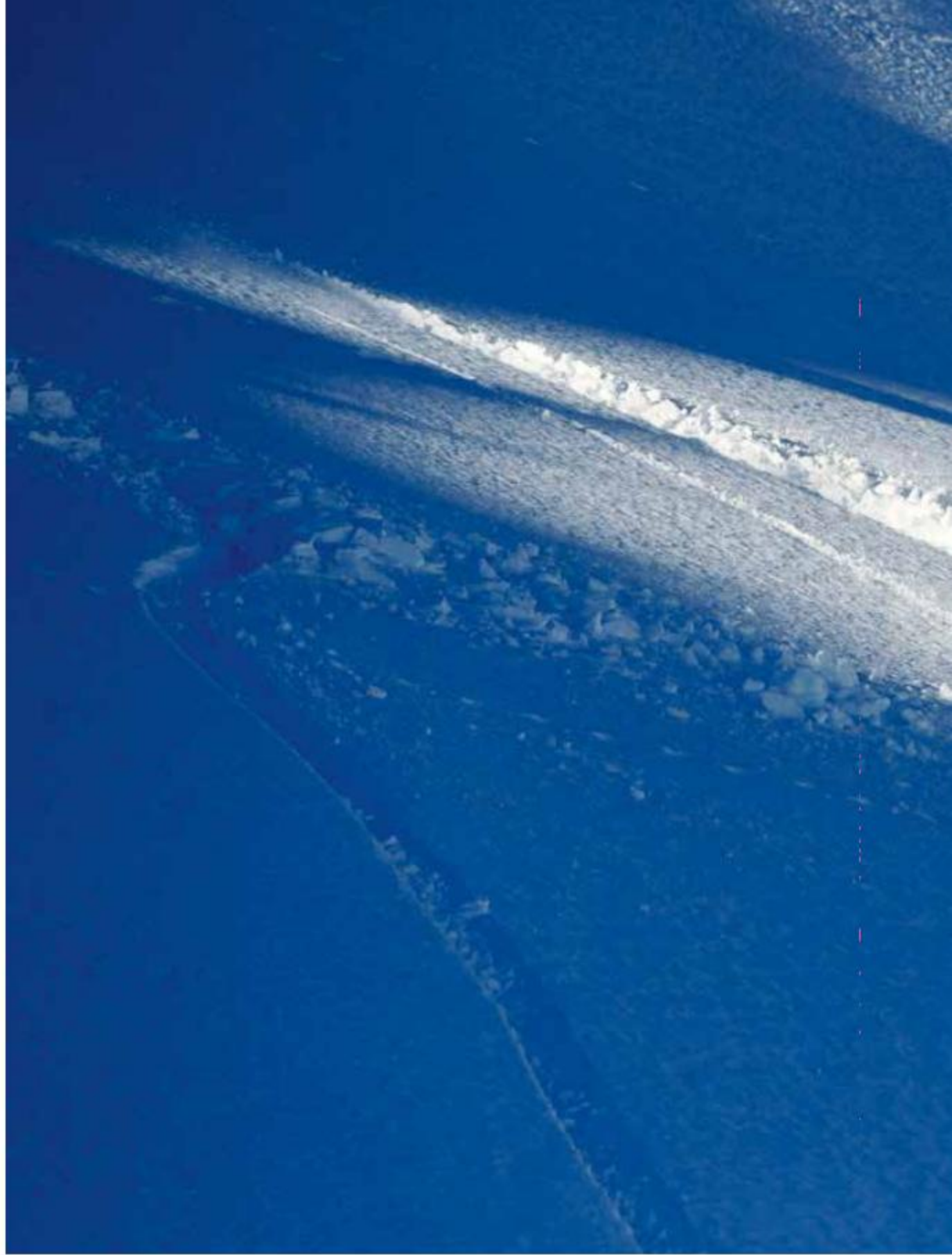



**'NOTHING COMPARES
TO BOMBING DOWN A
MOUNTAIN, TAKING OFF
YOUR CLOTHES AND
JUMPING INTO A HOT
SPRING'**



AUSTRALIA

25.2744° S 133.7751° E

READY FOR XVENTURE: AUSTRALIA

WHERE:

Sydney Harbour to Byron Bay, Australia.

WHEN:

"The best time of year would be January to February when the sea is calm, and the heat is so strong you wouldn't want to be anywhere else but in the ocean."

UNIQUE:

"Sydney Harbour has to be one of the most elegant harbours in the world, with the Opera House being the crown jewel. Once you leave the network of coves and ports, you can sail north to Seal Rocks and Byron Bay, two of the most magical beaches on the continent. Crystal clear water with perfect white sand beaches gives Hawaii a run for its money, while the art and food scenes rival that of anywhere in the world."

WHAT TO BRING:

"Jump on a Jet Ski (and take a good pair of hiking shoes) as the Australian coastline has some of the most dramatic hikes and scenic drives that lead to incredible waterfalls and viewpoints of the jungle."

SPECIAL ENCOUNTERS:

"Take XVenture's 8m Limousine tender ashore to spot koalas, kangaroos, emus, and other wildlife. As you sail up the East Coast, humpback whales present themselves everywhere, and the food is top notch."

CONSERVATION:

"Byron Bay is one of Australia's premiere destinations, but the area is tightly run to respect the natural beauty and wildlife. Taking great care, it is possible to see the whales migrate past the most eastern tip of Australia, without leaving a footprint."

'AS YOU SAIL UP THE EAST COAST, HUMPBACK WHALES PRESENT THEMSELVES EVERYWHERE, AND THE FOOD IS TOP NOTCH'





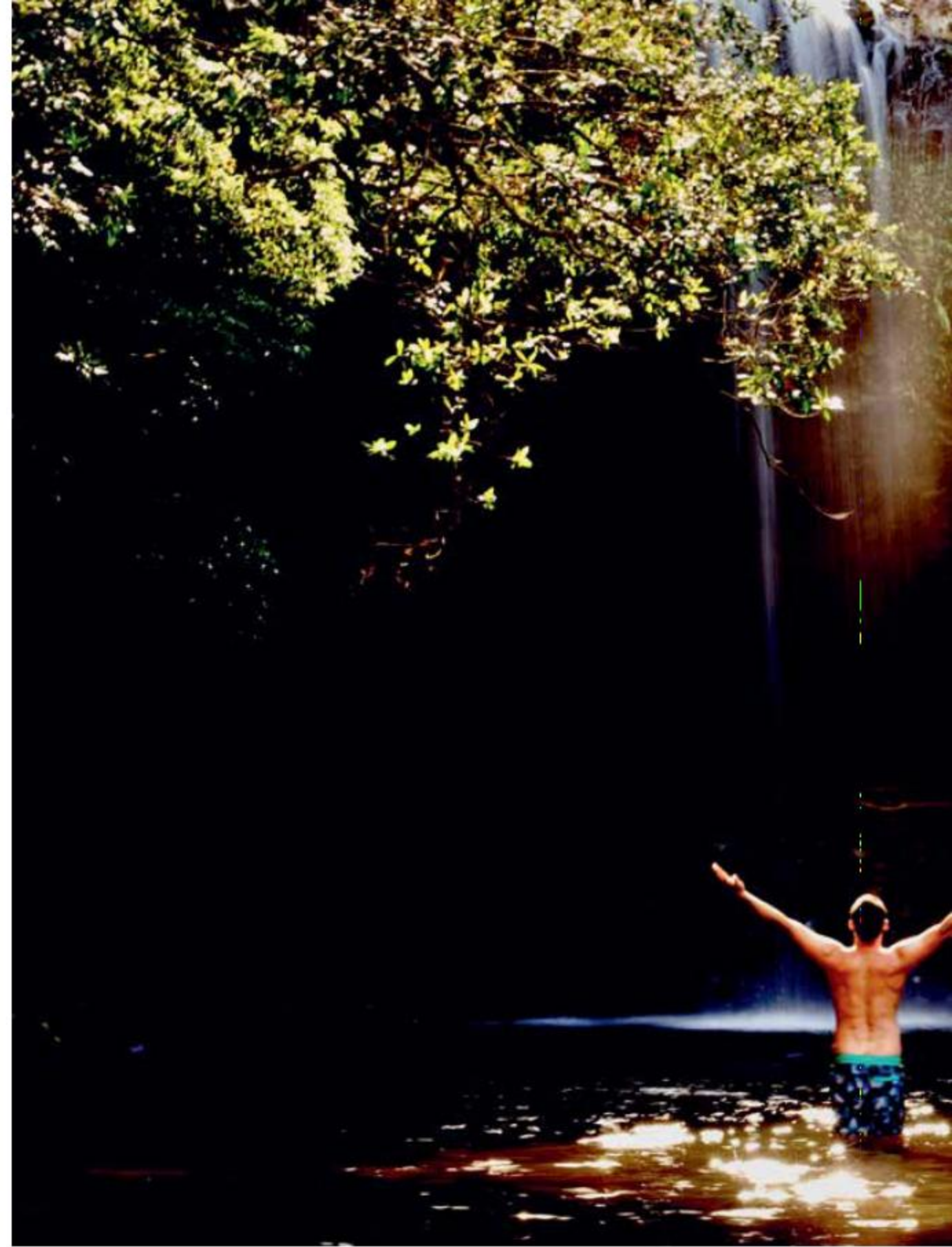



**'THE AUSTRALIAN
COASTLINE HAS SOME
OF THE MOST DRAMATIC
HIKES AND SCENIC DRIVES
THAT LEAD TO INCREDIBLE
WATERFALLS'**



TAHITI

17.6509° S 149.4260° E

READY FOR XVENTURE: TAHITI

WHERE:

Tahiti, Moorea, Bora Bora.

WHEN:

"All of the islands are magical year-round, and because of their relative exclusivity, are largely uncrowded. The whales are most present in September to November, and the best surf conditions to witness the world famous Teahupo'o waves can be found in May through to July."

UNIQUE:

"The mountains, jungle, and sea that comprise Tahiti are truly spectacular. Water clarity spans hundreds of metres, and the mountains radiate a mythical presence that redefine your understanding of natural beauty. The scuba diving is world-class, with incredible lagoons and marine life on hand."

WHAT TO BRING:

"XVenture is stocked with plenty of scuba diving gear, or alternatively take one of the Sea Bobs into the lagoons and reefs will also showcase an endless bounty of marine life and vibrant coral."

SPECIAL ENCOUNTERS:

"There is no better place to swim with whales, stingrays and sharks, not to mention hiking the mountains of Teahupo'o to hidden waterfalls and wild horses."

CONSERVATION:

"Tahiti is very ecologically conscious and is keen to instill how its people live amongst nature, not on top of it. Jump in the Intrepid 375 Sports fishing boat and watch the local fishermen catch tuna sustainably by harpooning from their fast Pangas; it's a truly unique and modern rendition of how the Polynesians have hunted for thousands of years."

'THE SCUBA DIVING IS
WORLD-CLASS, WITH
INCREDIBLE LAGOONS AND
MARINE LIFE ON HAND'









**'IT IS A TRULY UNIQUE AND
MODERN RENDITION OF
HOW THE POLYNESIANS
HAVE HUNTED FOR
THOUSANDS OF YEARS'**





XVENTURE PROVIDES LUXURY WITHOUT COMPROMISE, AND ADVENTURE WITHOUT LIMITS



ANDREW WINCH
WINCH DESIGN

A vertical line extends downwards from the bottom of the circle.

DESIGN TO INSPIRE

XVENTURE PROVIDES LUXURY WITHOUT COMPROMISE, AND ADVENTURE WITHOUT LIMITS. 'SHE WILL BE A GREAT 'STEPPING-STONE' FOR YACHT OWNERS WHO PERHAPS WANT MORE OF A RUGGED YACHT, BUT WITH ALL OF THE COMFORTS OF A TRADITIONAL YACHT.

Exploration, adventure and experiential travel. From dropping anchor in the wilds of Patagonia to navigating America's Cup waters around the Pacific Islands. Being enveloped by nature and capable of cruising anywhere. This is the central premise to the design of Heesen's rugged XVenture – the first of the Dutch shipyard's 'expedition' yachts.

"Being on the ocean and viewing wildlife up close; it's at the heart of the yacht, and was always in mind when developing the project," says Andrew Winch of British studio Winch Design, which conceived the interior and exterior in conjunction with Heesen. XVenture contains an enormous interior volume for her 56.7m length. When combined with her rugged good looks and autonomous capabilities, she captures the imagination of those looking for action-packed adventure in a truly luxurious setting.

XVenture has been depicted as 'less of a rugged Land Rover and more of a luxury Range Rover', a description that is epitomised by her distinct silhouette. "She will be rugged, but refined, with some key signature lines," explains Winch, who likens XVenture's appeal to "the commanding presence felt on the road" when driving a Range Rover. "XVenture will have an equally powerful presence on the water," he says.

The FDHF hull is constructed out of exceptionally tough steel and paired with a lightweight aluminium superstructure. Built to the highest Lloyds Classification and safety standards XVenture is the ideal vessel on which to make extended offshore passages. A remarkable cruising range of 5,000 miles (with even longer range as an optional extra) enables her to reach far off ports and to remain on station longer than other yachts.

'Being on the ocean and viewing wildlife up close; it's at the heart of the yacht, and was always in mind when developing the project'

Not just built to accommodate rough waters, however, her design pays respect to the oceans and wildlife that she seeks out. A hybrid propulsion system means exceptionally low noise and vibration levels. She also conforms to the latest Tier III exhaust and pollution emission regulations to reduce her environmental impact, while her FDHF hull makes her highly fuel efficient.

On board, she boasts a unique layout, luxurious interiors, and an impressive storage facility for tenders and toys. "XVenture will not compromise on the 'go anywhere' capabilities of an explorer but will combine all of the features associated with a traditional yacht," says Winch. "For us, it is very important for an explorer to have great views from everywhere on board; this philosophy has been in mind throughout the design process."

Floor-to-ceiling glass windows afford views out to sea from the main deck guest cabins and Owner's full-beam stateroom, as well as the upper deck saloon. A spectacular glass-ceilinged winter garden on the observation deck provides sprawling vistas from every angle with a swimming pool forward. Natural light shines through the central staircase skylight, which is directly connected to a second winter garden and aft deck lounging area.

"Everything revolves around being immersed in different environments and making the most of seeing them from different parts of the boat," says Winch, "especially looking forward, to the sides and to the sky."

XVenture's key design feature, however, is the access that she provides to various transport methods for a variety of expeditions, whether it be a helicopter, large tender, jet skis or submarine if the owner chooses. A

double height garage accommodates a 11.4m Intrepid 375 Sports fishing boat port-side, with a second 8.6m Beachlander in a side garage; these are unusually large tenders designed to allow guests to move to and from shore in great comfort and variable weather conditions. They are also ideal for carrying extensive gear required for local expeditions. Jet Skis, scuba diving equipment storage, a 4.5m crew tender and storage for fishing equipment and small toys are neatly accommodated, as is the option to carry an Airbus H135 (or equivalent) helicopter to visit remote areas for heli-skiing or heli-fishing.

A remarkable cruising range of 5,000 miles enables her to reach far off ports and to remain on station longer than other yachts

"XVenture will be a great 'stepping-stone' for yacht owners who perhaps want more of a rugged yacht, but with all of the comforts of a traditional yacht," says Winch. "We are certainly very excited to be involved in such a project."



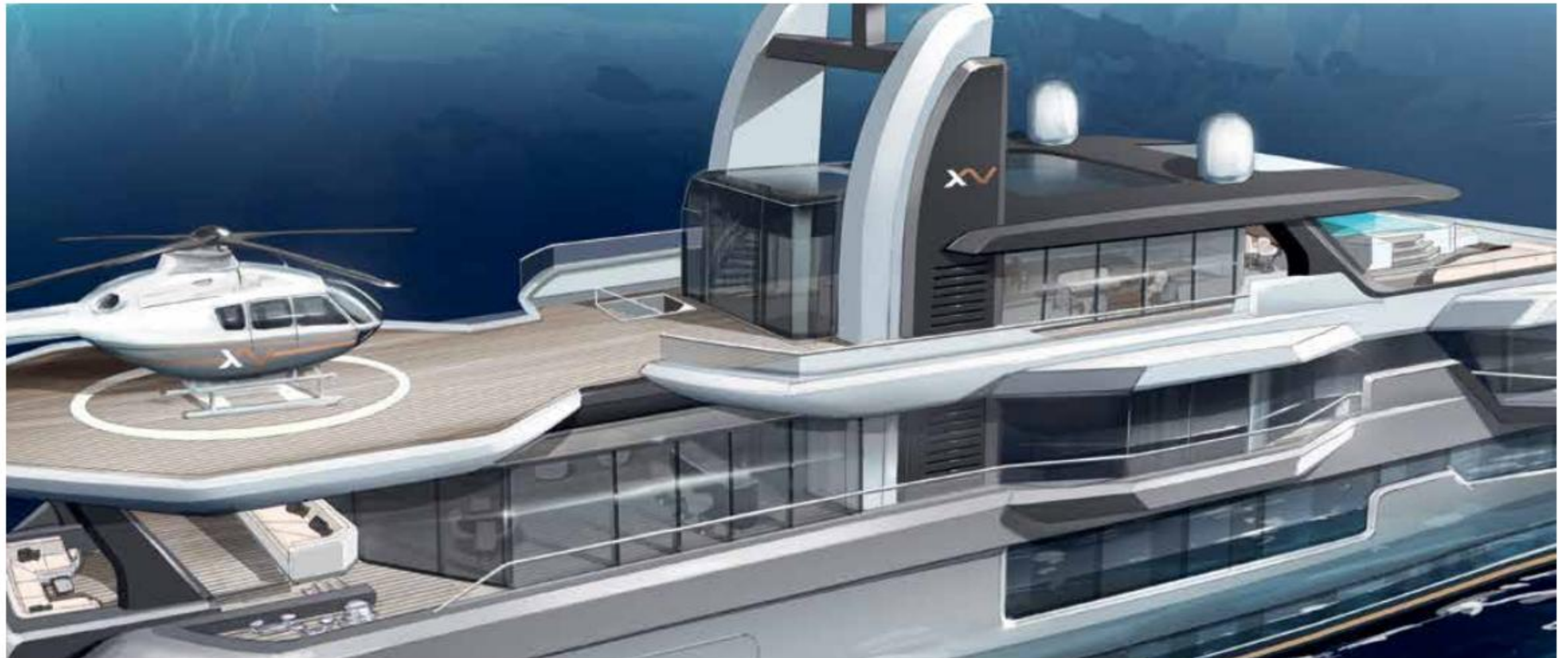

A SPECTACULAR GLASS-CEILINGED WINTER GARDEN ON THE OBSERVATION DECK PROVIDES SPRAWLING VISTAS FROM EVERY ANGLE

TOYS FOR EVERYONE

PUTTING THE 'FUN' INTO FUNCTIONAL, XVENTURE IS CAPABLE OF CARRYING AN IMPRESSIVE VARIETY OF TOYS AND TENDERS, ALL OF WHICH ENSURE THAT NO MATTER THE LOCATION, THE ADVENTURE NEVER ENDS.



INTREPID 375 SPORTS FISHING BOAT

At nearly 12m in length, the Intrepid 375 Sports fishing boat is an unusually large tender to be stored on board a 57m yacht, boasting a versatile layout for a day spent fishing on the water.



JET SKIS X 2

Fun, fast and perfect for exploring hidden bays, a pair of Jet Skis are the ultimate water toys for adrenaline-fuelled adventure. Skim the wide-open waters of Chile or set off in search of the best surf beach.



ICREW TENDER

Neat and compact, this 4.5m tender is the perfect tender for transporting equipment and luggage from shore to boat. Serving as a support vessel to the other tenders and toys, it is the height of convenience.

COMPASS LANDING CRAFT

A true multipurpose working platform tender, affectionately known as “the pick-up truck of the seas”, is the ultimate vessel for bringing toys like motorbikes, quads and other gear to shore.





PASCOE DT BEACHLANDER

Offering a fast and comfortable ride, this 8.6m Beachlander boasts a clever opening bow door for stable and safe beach landings. Perfect when navigating those hard to reach places, and in destinations such as Alaska.



SCUBA DIVING EQUIPMENT

Having onboard dive equipment ready to use at a moment's notice ensures spontaneous fun is around every corner, and a neat storage facility means out of sight, out of mind.





SEABOB

The Seabob is a must-have toy to enjoy the crystal clear waters of Tahiti and Australia. It zooms powerfully and almost silently through the water.



SUBMARINE

Diving below the water's surface to explore the hidden depths is a dream turned reality for the owner of XVenture. For personal use or research purposes, the opportunities are endless.



DINGHY

The Laser is the world's most popular racing dinghy, perfect for fast sailing fun in the shallow bays of Australia or Tahiti.



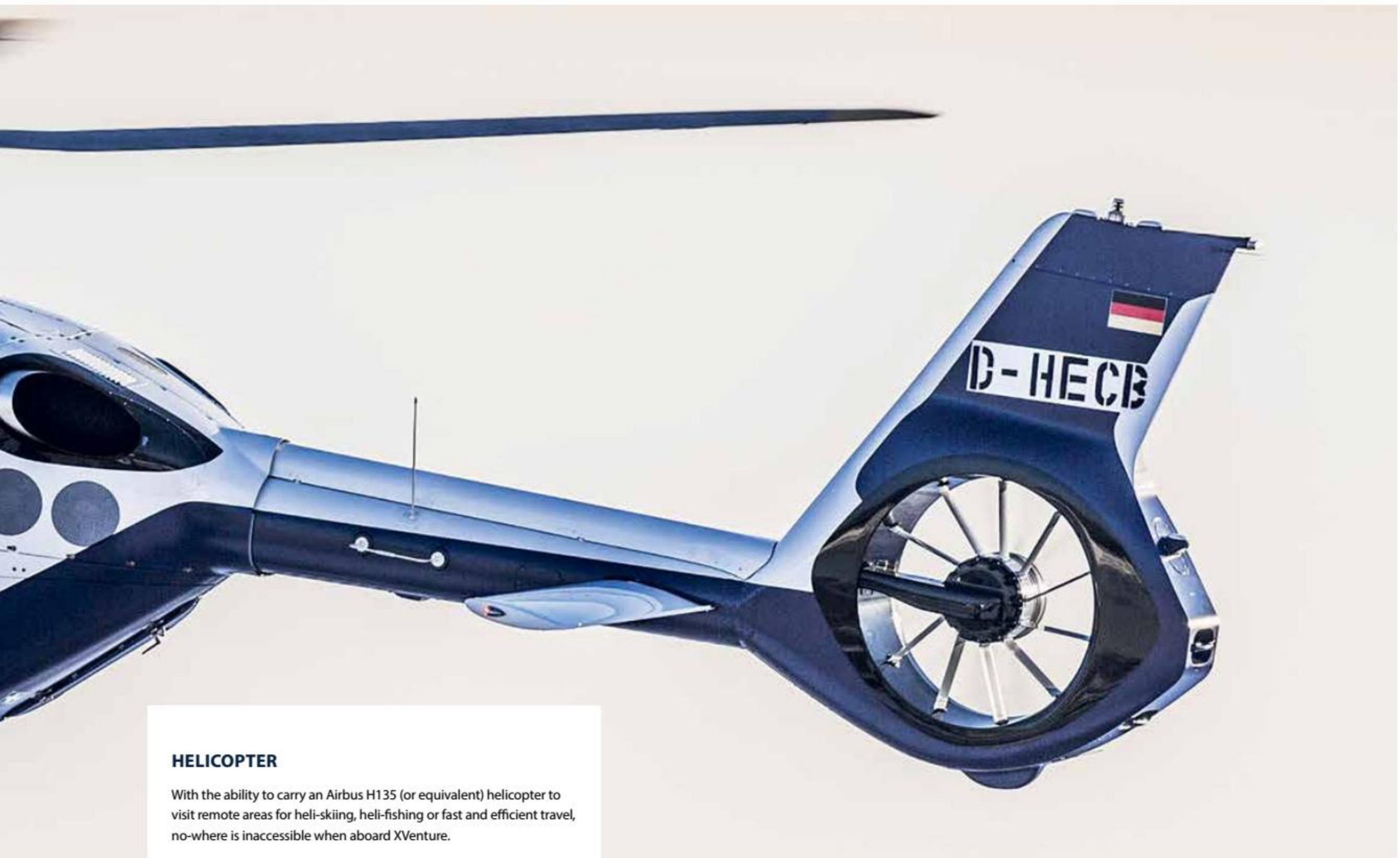

HELICOPTER

With the ability to carry an Airbus H135 (or equivalent) helicopter to visit remote areas for heli-skiing, heli-fishing or fast and efficient travel, no-where is inaccessible when aboard XVenture.

PROFILE: GREY



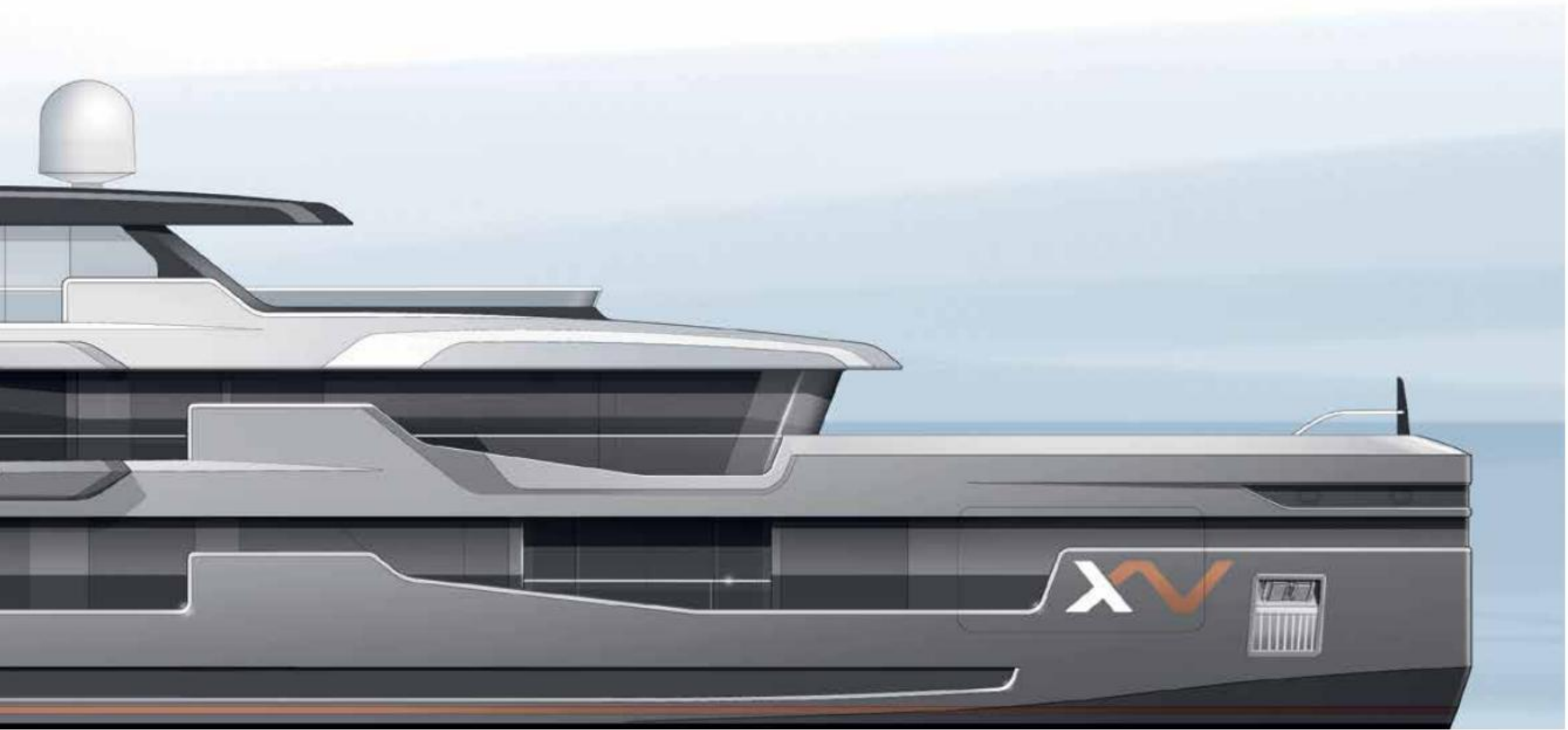

PROFILE:
WHITE



PROFILE:
WHITE-BLUE



PROFILE:
COPPER BLACK



PROFILE:
NAVY-BLUE

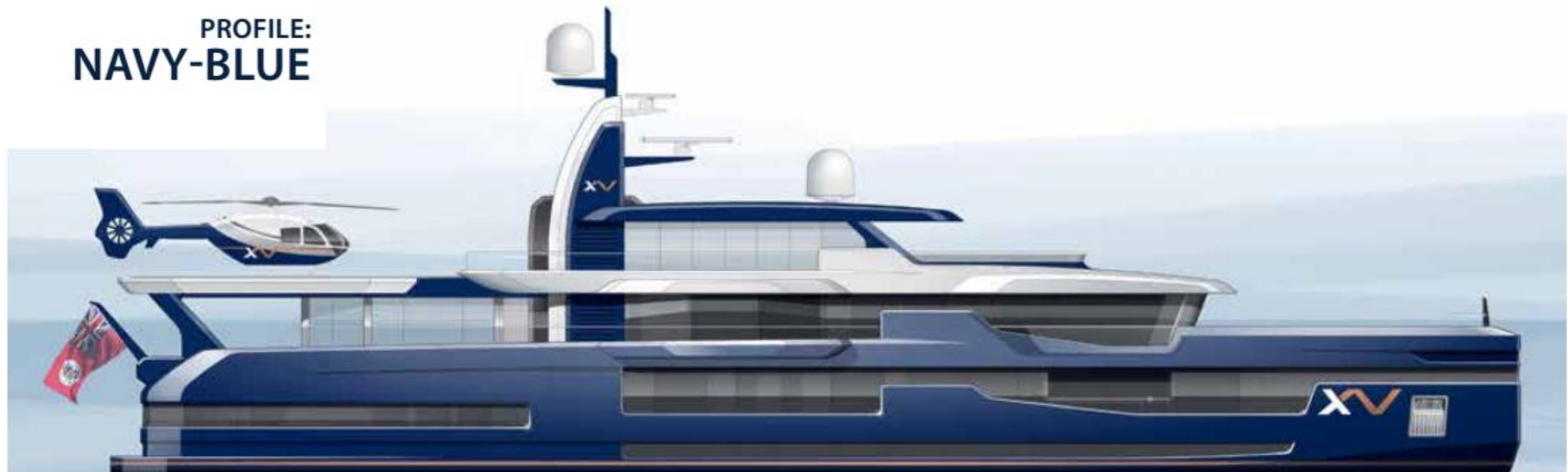

GENERAL ARRANGEMENT 57M

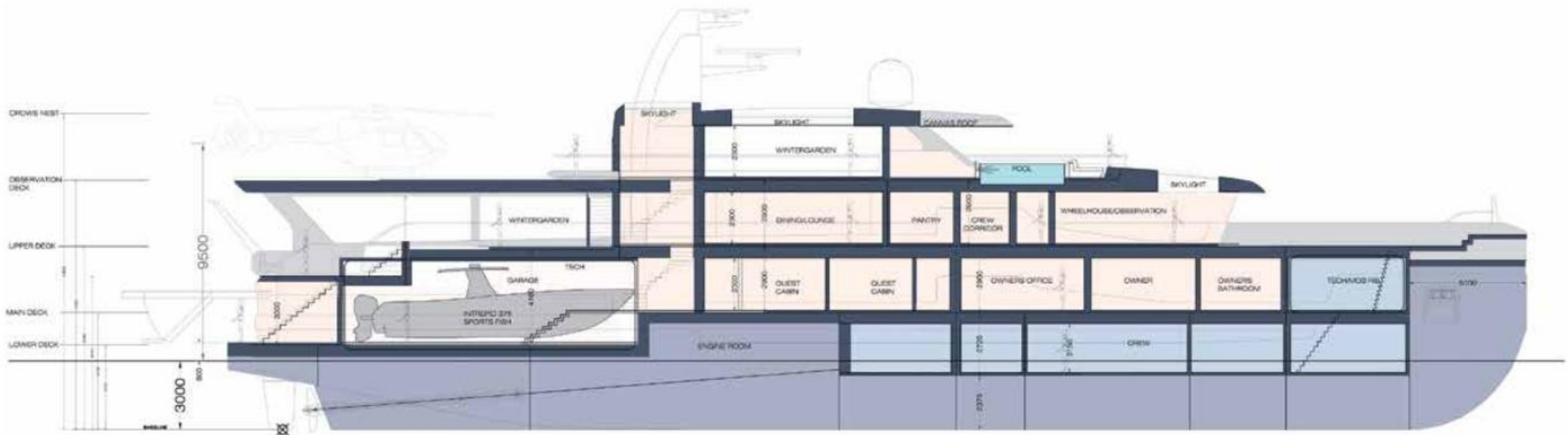

48M



57M

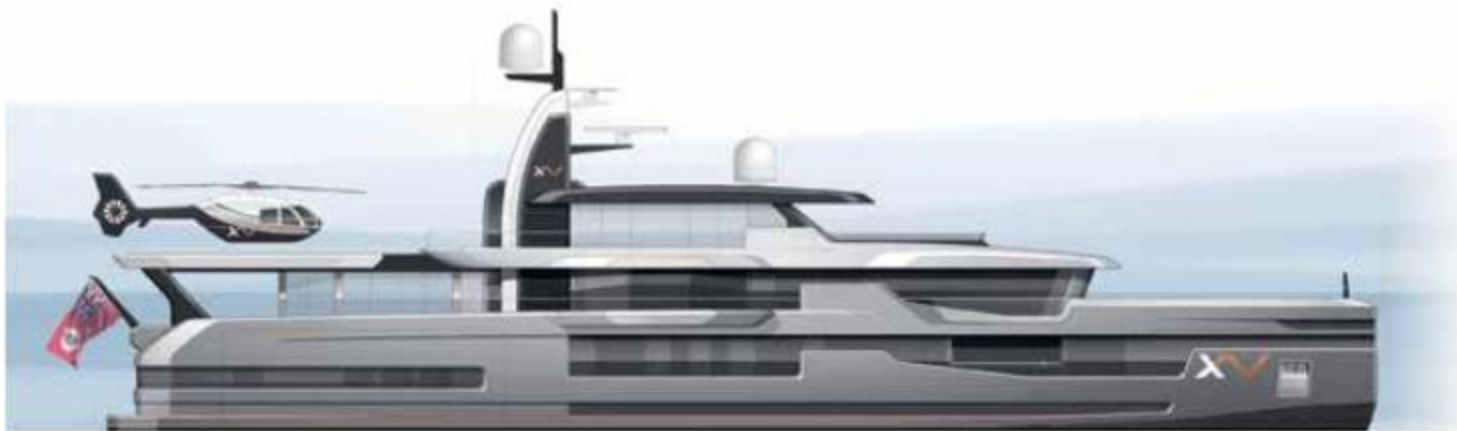

65M



GENERAL ARRANGEMENT 57M

CROW'S NEST

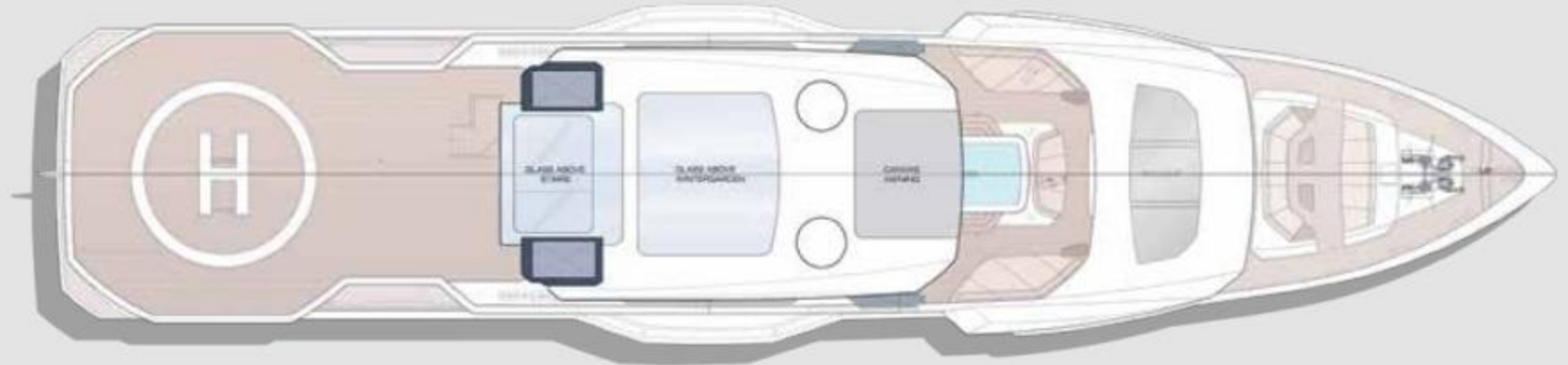

OBSERVATION DECK

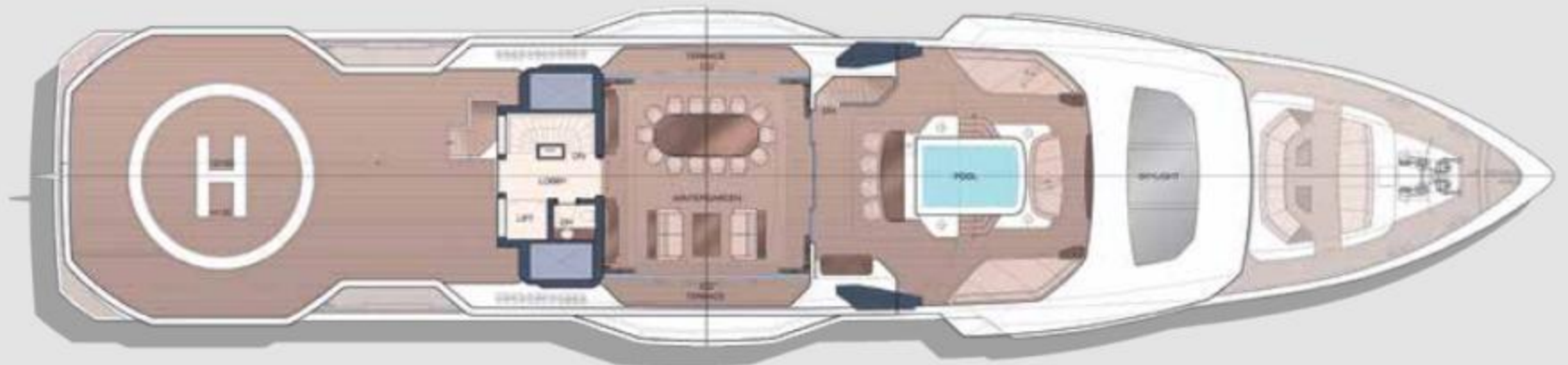



UPPER DECK

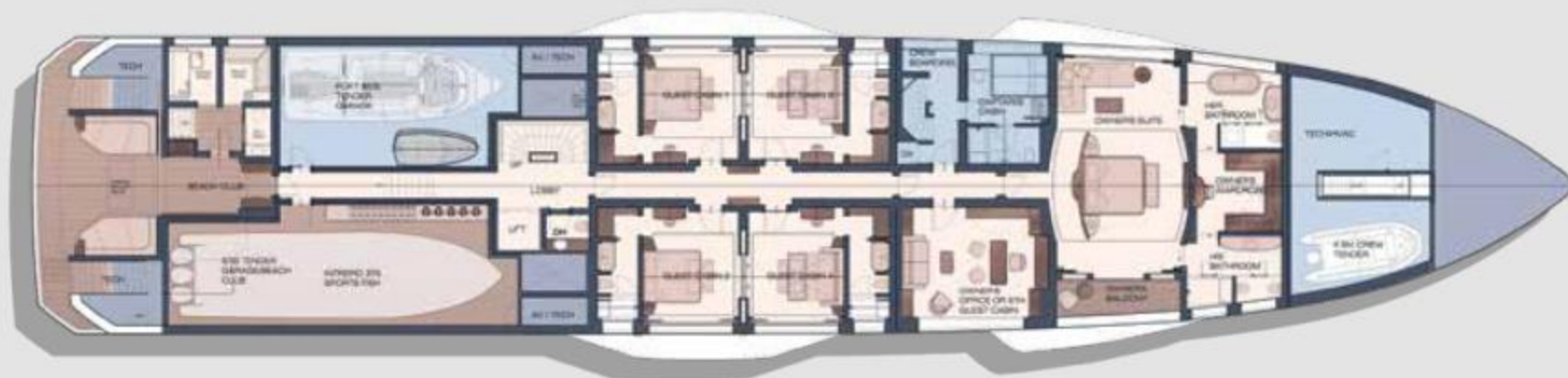

LOWER DECK



SPECIFICATIONS

57M

GENERAL

Hull type:	Twin propeller, FDHF
Naval architect:	Van Oossanen Naval Architects / Heesen Yachts
Exterior design:	Winch Design
Interior design:	Winch Design
Classification:	ABS ✱ A1 Commercial Yachting Service ✱ AMS Large Commercial Yacht Code LY3
Hull:	Steel
Superstructure:	Aluminium

DIMENSIONS

Length over all:	56.70 metres / 186 feet
Beam over all:	10.9 metres / 35 feet 9 inches
Draft (half load):	3.0 metres / 9 feet 10 inches
Displacement (half load):	to be determined
Tonnage:	Approx. 1,280 GT

ACCOMMODATIONS

Crew:	17
Guests:	12
Cabins:	Full-beam owner's stateroom, five double guest suites

TECHNICAL DETAILS

Maximum speed (half load):	16 knots
Range at 12 knots:	5,000Nm
Fuel capacity:	to be determined
Fresh water:	25,000 litres / 6,600 US Gallons

PROPULSION DETAILS

Main engines:	2 x MTU 12V 4000 M65L (IMO Tier III)
Maximum power:	2 x 1,920kW
Gearbox:	2 x ZF 7661
Engine control:	MTU Blue Vision (New Generation)
Propellers:	2 x five blade fixed pitch
Main generators:	2 x Zenoro, 300kW
Bowthruster:	250kW, electrically driven
Stabilisers:	Naiad Dynamics, 2 fins, zero speed



OUR PHILOSOPHY

AT HEESEN WE DON'T JUST BUILD YACHTS. WE TURN DREAMS INTO REALITY.

For more than 40 years, Heesen has pursued a consistent mission: to create yachts with exceptional standards of engineering and meticulous attention to detail. To achieve this, skilled hands, driven by a passion for perfection, make all the difference. They are able to fulfil every customer's dream.

Our craftsmanship is matched with a hunger for innovation, creating designs that continuously push the limit. But the Heesen experience goes beyond building a perfect yacht. It's all about exceeding the client's expectations with first-class service at all times.





DESIGN & DEVELOPMENT

LESSONS IN AESTHETICS & EFFICIENCY

The secret of our success? If there is such a thing, this is probably it: to build yachts of a constant quality and beauty while fulfilling every client's dream – over and over again. Heesen does this by maximising efficiency, which in turn gives the organisation more freedom to innovate and deliver a quality product with attention to detail, along with the very best service.

Preferred length, speed and seagoing requirements are all the information a designer needs to give tailor-made advice about the design possibilities available. Heesen uses an extensive database with results from tests with yachts of every length and shape imaginable. Until recently, this data could only be collected by running physical tank tests on prototypes. Nowadays, these tests are still being performed, but only to fine tune the results from virtual tests using Computational Fluid Dynamics (CFD) software. These

digital tests make it a lot easier to pre-test a design and to assess the yacht's feasibility, allowing the database and product portfolio to progress more quickly.

Extensive menu

Currently, the shipyard offers an extensive menu of hull types and innovations to choose from in order to create the perfect yacht design for each client. Some recent innovations include the Fast Displacement Hull Form (FDHF) and Hull Vane technology developed by Van Oossanen. With every new yacht design, Heesen is challenged to find new solutions – innovations from which every future Heesen yacht benefits.

Physical tank test

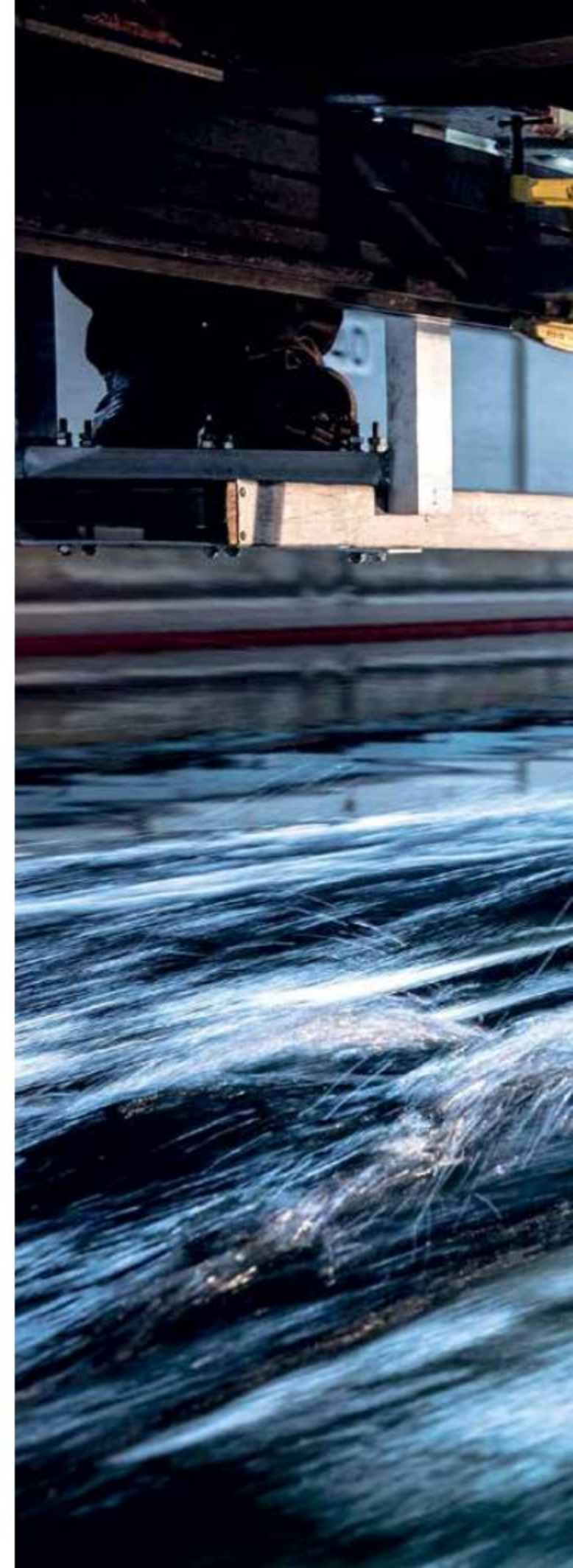

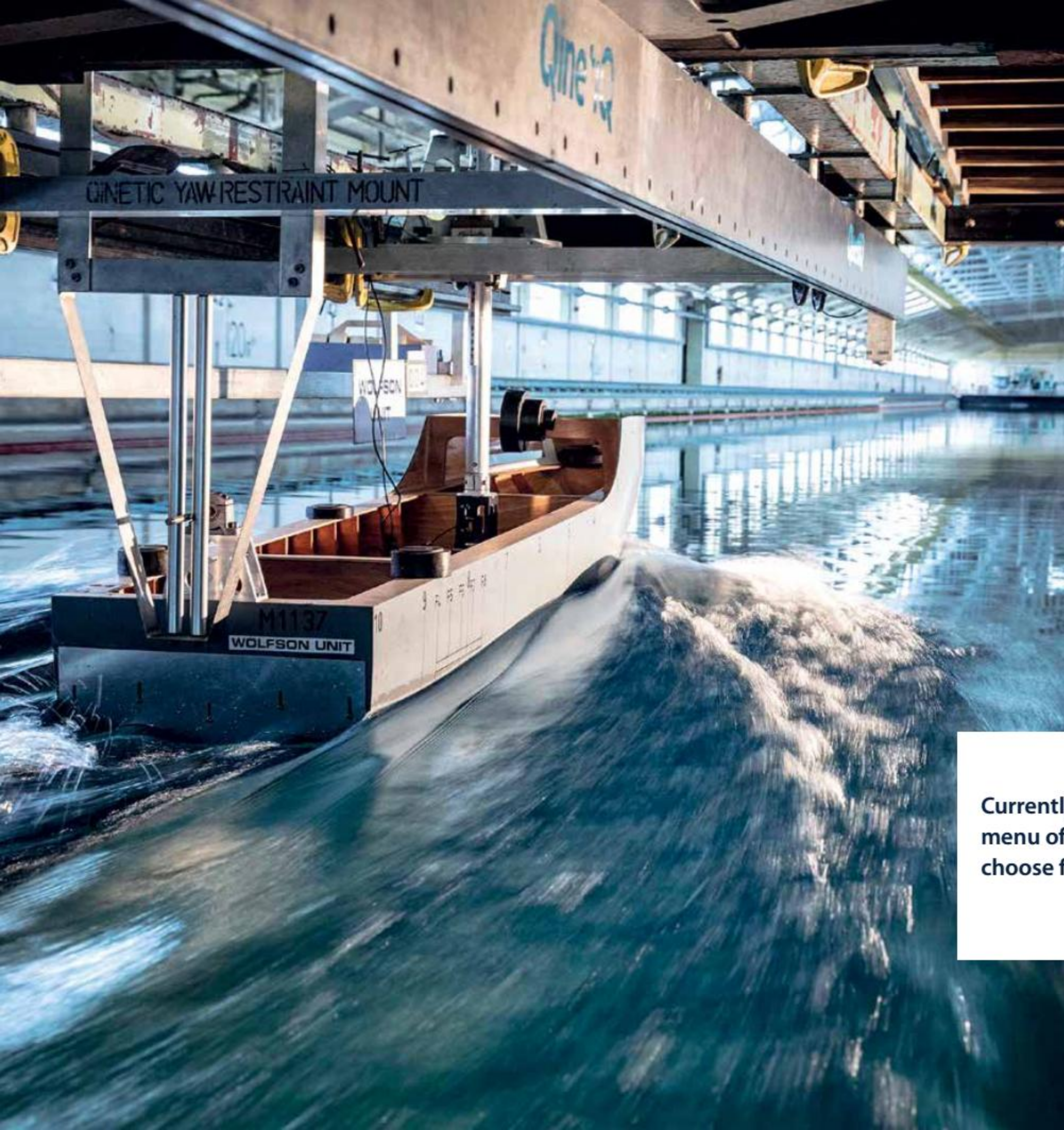

Currently, the shipyard offers an extensive menu of hull types and innovations to choose from

Yacht building

HIGHTECH CRAFTSMANSHIP

Building a yacht is probably one of the most complex processes you can undertake. Few products involve more skills and technology. And in this high-tech era of robots and fully automated production, a Heesen yacht is still largely crafted by hand.

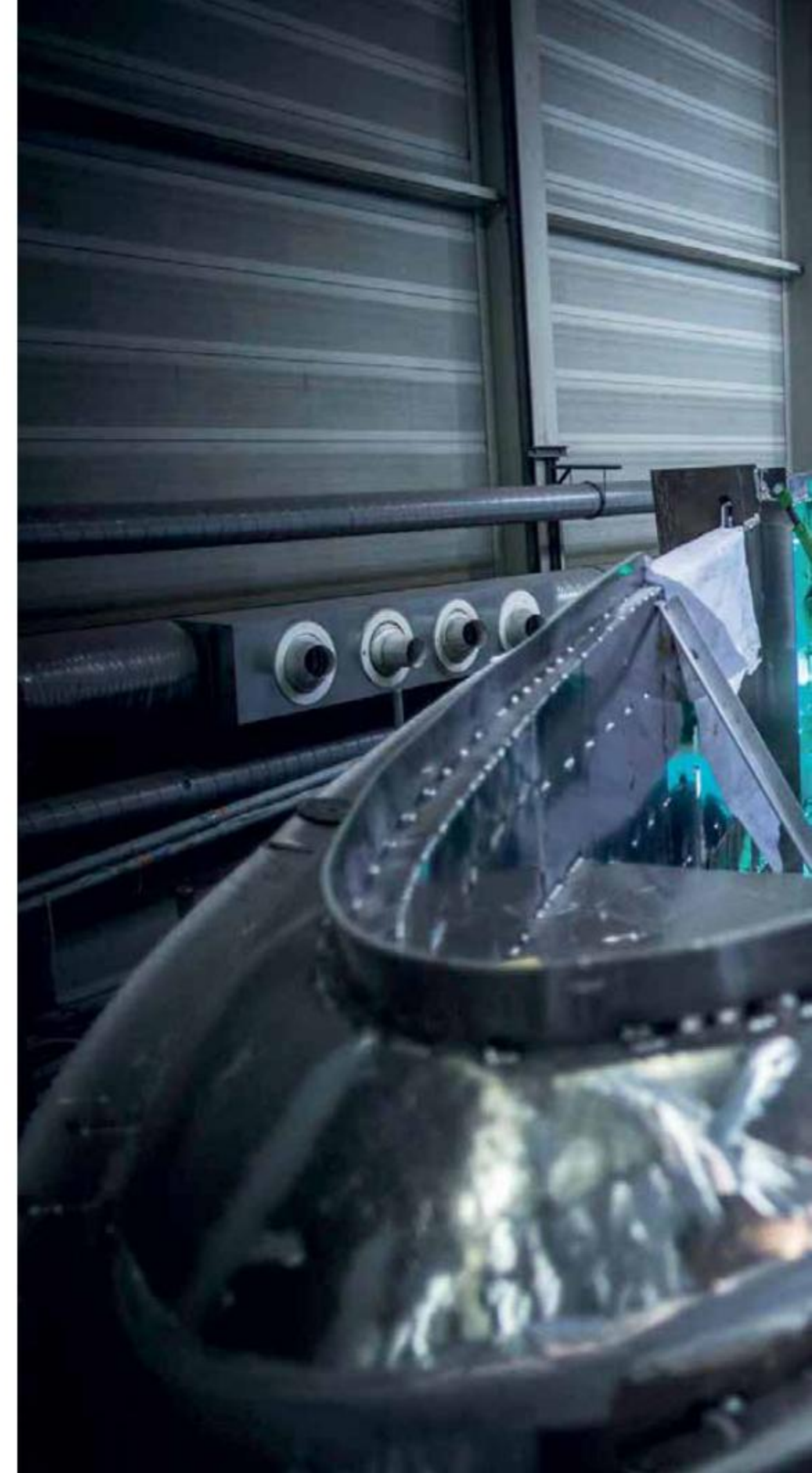



Heesen's modern Oss shipyard builds from 40 to 83 metres, all on site

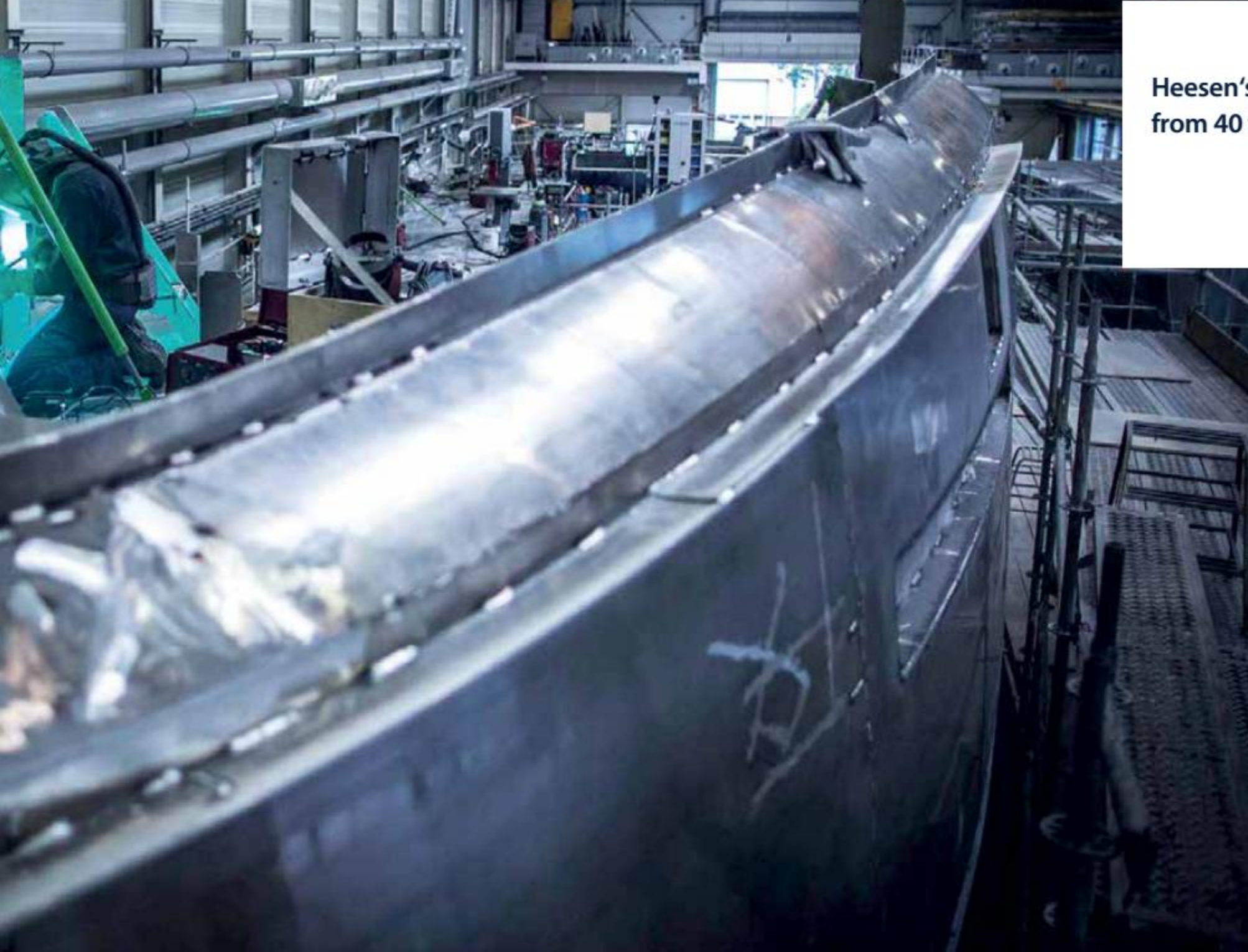

THE DESIGN COMES TO LIFE

The backbone of each Heesen yacht is a hull welded to perfection. It is always a magical moment when the first contours of the hull appear and the yacht's design comes to life. Heesen uses aluminium – which requires highly skilled and experienced welders – and steel to construct. In 2016, the shipyard used approximately 265 tonnes of aluminium and approximately 475 tonnes of steel to build 4 yachts – 2 steel and 2 aluminium hulls.



A PERFECT FINISH

Several layers of epoxy primer are applied to the aluminium and steel surfaces of the yacht, giving the hull and superstructure a smooth finish and a perfect basis for the paintwork. It takes a trained eye and skilful hands to apply each layer of coating and paint with exactly the right thickness.

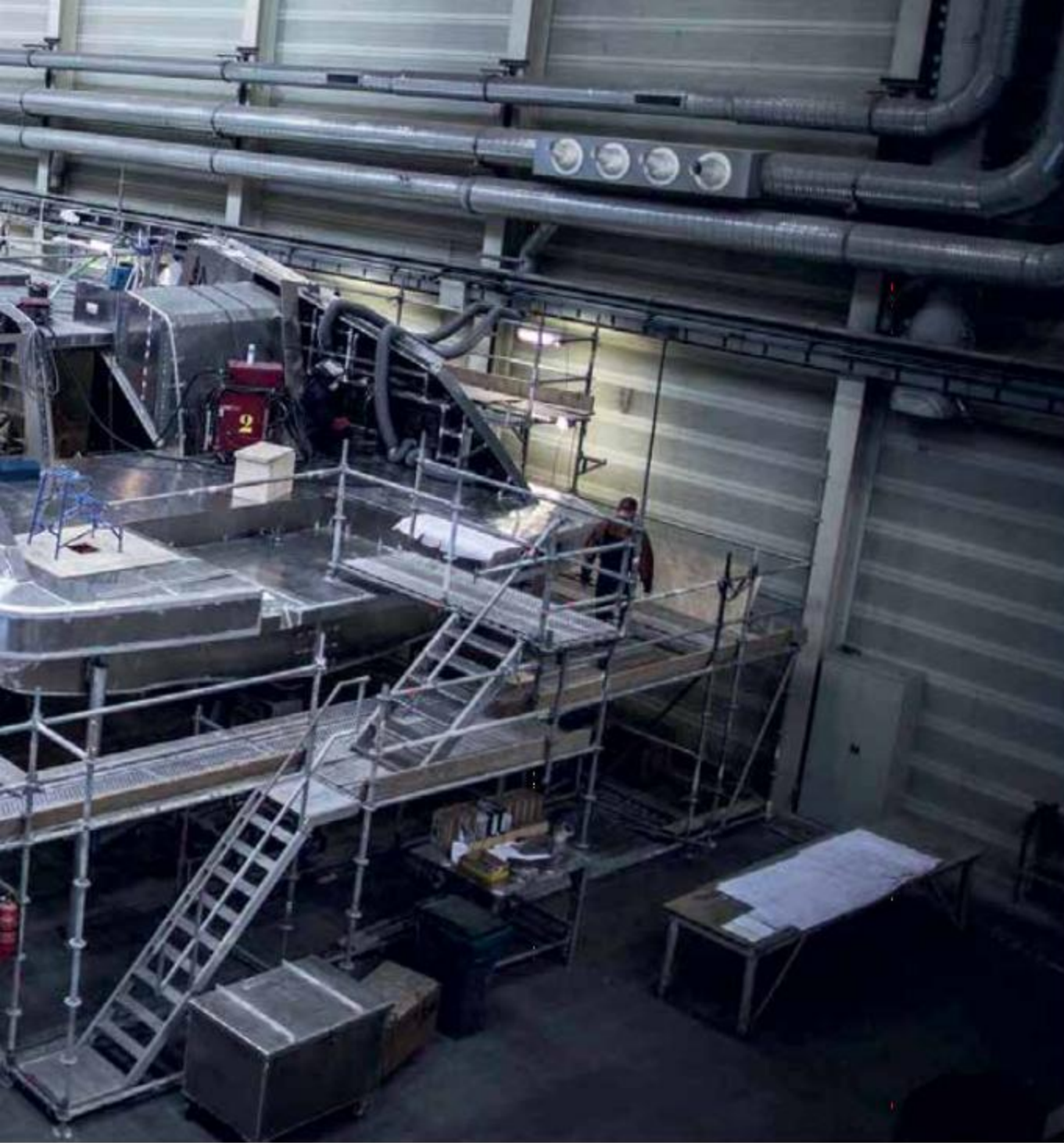

THE MARRIAGE

The definitive shape of the yacht is determined by another key moment in the building process: the marriage, when the hull and superstructure are joined. It is all about perfect timing and precision when the crane operator lowers the superstructure onto the hull.

Heesen interiors

HAND-BUILT IMAGINATION

As one of the few yacht builders to have an entire in-house department of interior specialists, Heesen guarantees consistent quality and custom design solutions that spark your imagination.

'Heesen builds its yacht interiors entirely in-house, a service that differentiates the shipyard from others in the world and enables it to guarantee the quality it promises'



INTERIOR WORKSHOP

The shipyard's main interior workshop is situated in Winterswijk, just over an hour's drive from Oss, and provides more than 8,100 square metres of working space. Here, a large group of craftsmen work on up to five Heesen projects at the same time. This is where all of the luxury areas – such as the atrium, saloon, dining, owner's stateroom and guest suites – are created. At the shipyard in Oss, another 30 craftsmen work on the interiors of all the service areas and sky lounges.

Rather unusually in this industry, Heesen builds its yacht interiors entirely in-house, which requires every type of machinery and skill on location. 'This is something that has evolved over the years and we are very proud of it,' Henry Schreur, director of Heesen Interiors, explains, 'because we have been responsible for many award-winning yacht interiors.' Schreur refers to the acclaimed My Sky, Galactica Star, Elena, Amore Mio and Galactica Super Nova.

This requires a lot of talent. It is one reason why Heesen invests heavily in the acquisition of young talent.

Mock-up

The interior construction process consists of two phases. At first, the in-house interior department generates a four-square-metre mock-up of the proposed interior. This is a full-sized, fully finished interior fitted with handles, switches, lamps and even fabrics and flooring. If the owner agrees with the concept, the interior department then starts creating workshop drawings and sources all the materials, from the exotic to the everyday.

Exquisite materials

Once completed, the interior reaches the second phase – the actual creation process, which starts at both atelier locations. The craftsmen work with some exclusive wood types, including teak, wengé, Macassar ebony, walnut, flamed maple, as well as stained and curved glass, ray and goat skin, 3D printed elements, marble, onyx and other minerals. There are no limits to what the in-house interior specialists can create: the challenge lies in processing the materials in the right way.

Perfect finish

Naturally, raw materials such as bamboo, wood and leather differ from each other in their colour or texture. So to create uniformity, the interior specialists have to carefully treat each piece of wood by bleaching or staining, or colour the animal skin. As well as the material challenge of ensuring every piece looks exactly like its proposed design, weight, dimensions and time are other constraining factors for the craftsman involved. However, even with last-minute changes, these professionals never take short cuts and always ensure that they install everything with a perfect finish.





Sanding cabinets



Furniture construction



Sealing the decks

INTERIOR ASSEMBLY

All of the interior components are created in the wood shops in Oss and Winterswijk and are then assembled and finished on the yacht itself, which requires many different skills for a perfect result.

COMPANY

AFTER SALES & YACHT SERVICES

With an ever-expanding fleet of superyachts cruising the world, it was natural to broaden the scope of services and launch a comprehensive programme called 'Yacht Services by Heesen' alongside the shipyard's existing After Sales programme. The in-house programme consists of four pillars to enhance the overall owners' experience and improve the operational reliability of their assets.

Taking delivery of a Heesen yacht is the start of a journey – a carefree journey, thanks to the support of Heesen's After Sales programme, which ensures premium care and provides maintenance and technical support

throughout her entire lifespan. From the instant our skilled team of workers finish building the yacht, she is placed in the caring hands of our After Sales team, who put her to the test in a sea trial and make sure everything works exactly as it should. And from that moment on, our After Sales experts keep watching over the yacht, ensuring she stays in peak condition. On top of this, Heesen proactively reaches out to all owners with the four yacht services detailed on the following pages.



Engine room





Original Spare Parts & Provisioning

We ensure operational reliability and avoid a delayed or cancelled cruise due to technical failures by offering original components at all times. To be able to offer this, the shipyard maintains excellent relations with all equipment suppliers to make sure that high-quality, warranty-protected and competitively priced parts arrive on time.



REFIT

This pillar was introduced to ensure that Heesen's Dutch quality standards can be maintained throughout the lifecycle of a yacht. Owners sometimes have to fall back on local shipyards and subcontractors when maintenance and repair work is required, This is why Heesen provides managerial assistance on necessary refit, repair and renewal work, either from a distance or on location. A flying squad of technicians is ready to travel at a moment's notice to any location in the world.

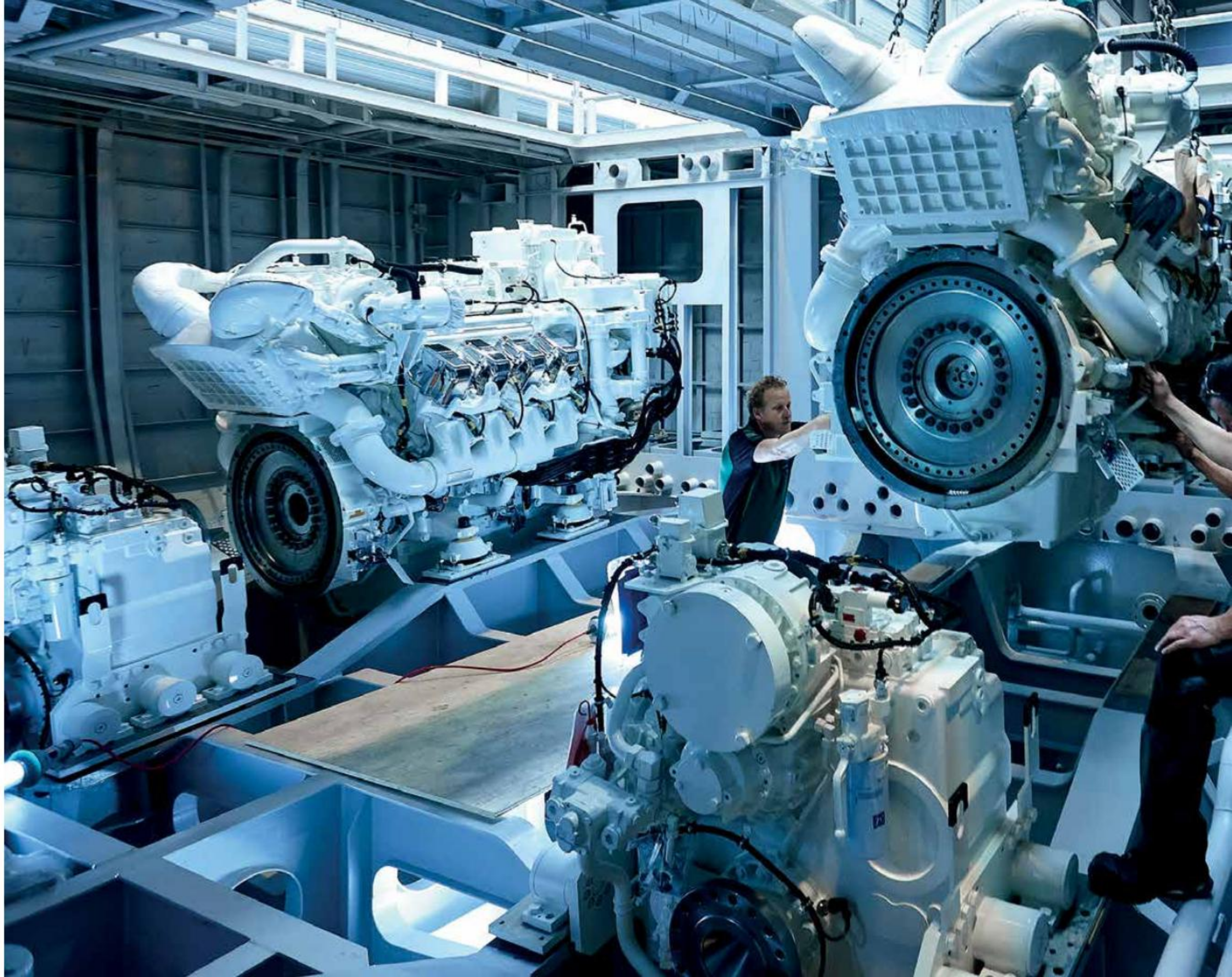



CUSTOMER SUPPORT & AFTER SALES

This department consists of a warranty and customer support team. Heesen's warranty team looks after all claims and warranty. Usually, warranty staff get involved a few months before delivery to make sure all parts are in excellent shape when the warranty period begins. Customer Support, on the other hand, provides general 24/7 support to any Heesen client in need, including on location with our flying squad.

More recently, the shipyard launched a new service: the annual survey. This thorough periodical check ensures that yachts are signed off every quarter during the warranty period and annually thereafter. This is a mutually beneficial check, guarding the operational reliability as well as our brand image. This shift from reactive towards preventive and eventually predictive maintenance support means an impressive leap forward in customer service for all Heesen owners.

STATE-OF-THE-ART SHIPYARD

DREAMFACTORY

Ever since Frans Heesen started out in 1978, the shipyard has continuously expanded and improved its infrastructure and docks. Today, it is one of the most advanced and well-equipped yacht-building facilities in the world.

The shipyard is located in the Dutch city of Oss, 150 kilometres inland and connected to the North Sea by a series of canals and rivers.

Its 22,000 square metres of covered area and 2,900 square metres of workshop space offer everything you need to construct a product as complex as a Heesen yacht. Production capacity has gradually increased with the addition of new docks. In 2016, following the success of the 65-metre Galactica Star and 70-metre Galactica Super Nova, a 90-metre shed and dry dock were completed. These new facilities allow the construction of yachts up to 83 metres entirely in-house.

1. 50-metre slipway
- 2/3. 85-metre dry dock
4. 50-metre dry dock
5. 70-metre dry dock
6. Aluminium construction shed
7. 57-metre dry dock
8. 57-metre dry dock
9. 57-metre dry dock
10. Technical department / warehousing
11. Carpentry
 - A. Offices
 - B. Warehousing
 - C. Crew offices
 - D. Storage

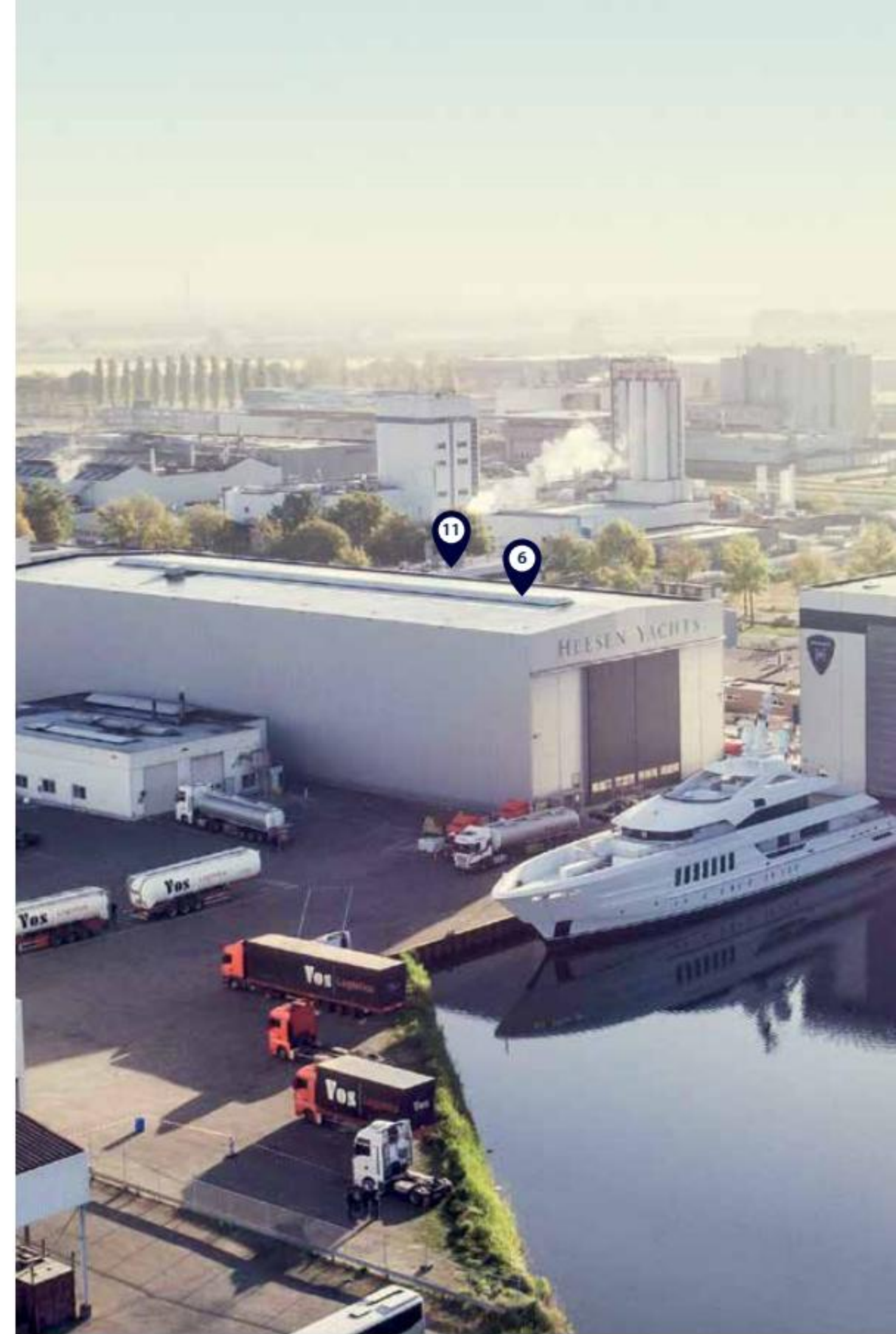



HEESEN

CONTACTS

HEADQUARTERS

Rijnstraat 2

5347 KL, Oss

The Netherlands

+31 412 66 55 44

sales@heesenyachts.com

heesenyachts.com

© Heesen Yachts Sales BV 2019. This brochure has been prepared for general marketing purposes. The information contained in this brochure (including without limitation any information concerning the dimensions, capabilities and performance characteristics of the subject yacht) is given in good faith but is not warranted to be accurate. All such information is subject to change at any time without notice. Heesen Yachts gives no warranty or representation, nor shall it be liable, in contract, tort or any other way, for any claims relating to or arising from any use made of any such information.

